



CATALOG & APPLICATION GUIDES



**INTENTIONALLY LEFT BLANK
FOR TWO-PAGE VIEWING**

EVERYTHING YOU NEED

TO ENJOY THE ROAD AHEAD

 **CURT**
curtmfg.com

 **RANCH
HAND**
ranchhand.com

 **ARIES**
ariesautomotive.com

LUVERNE
luvernetruck.com

 **UWS**
uwsta.com

RETRAC
retracmirrors.com



 **LIPPERT**

Lippert is a leading, global manufacturer and supplier of highly engineered products and customized solutions dedicated to shaping, growing, and bettering the RV, marine, automotive, commercial vehicle, and building products industries. We combine our strategic manufacturing capabilities with the power of our winning team culture to deliver unrivaled customer service, award-winning innovation, and premium products to every industry and person we serve.



BUSINESS AS A FORCE FOR GOOD



OUR VISION: TO BE A FORCE FOR GOOD IN THE WORLD

Since 2016, Lippert has focused on designing a cultural foundation from which our success is based, and it stems from one simple driving force: At Lippert, Everyone Matters. From the shop floor to the C-suite, we simply care about people. Our culture is grounded in our five core values that we practice in our business every day.

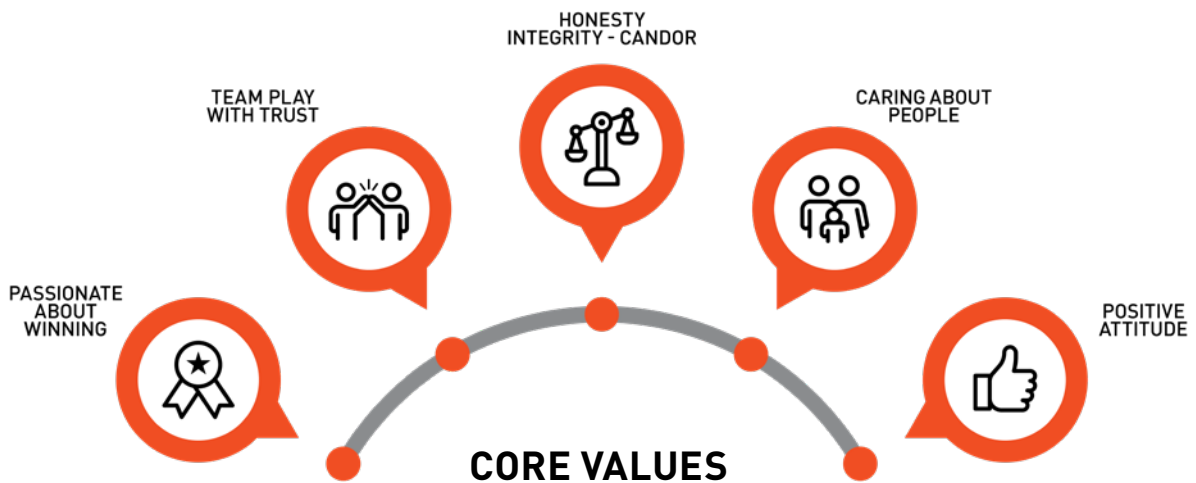

OVER EIGHT YEARS OF IMPACT



2,000+
non-profits served



950,000+
volunteer hours



\$2,000,000+
annually donated to charity



Scan to see
the impossible



IMPOSSIBLY STRONG

RIGIDCORE™ TECHNOLOGY

HIGH-STRENGTH, FOAM-FILLED LID

RigidCore™ is a patented technology built into the lid of UWS tool boxes. The lid is filled with a hardening, expanding foam material, sandwiched between two aluminum plates. As it hardens, the foam and plates create a solid structure. Hidden from view, RigidCore™ technology greatly enhances the lid strength, far beyond that of a traditional tool box.

THE RIGIDCORE™ ADVANTAGE

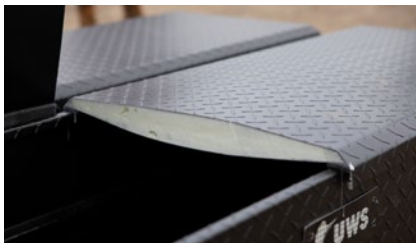

Foam-filled lid greatly enhances strength and overall structural integrity while preventing warping



The rigidity of the lid makes it highly resistant to binding and ensures smooth opening and closing of the tool box



RigidCore technology is completely integrated into the toolbox lid and is undetectable from the outside for a seamless, streamlined look



 **UWS**

BRAND 'X'

NEW

CROSSOVER BOX TIE DOWNS

21



Scan QR code to see how we take care of shipping!

HEAVY-DUTY PACKAGING
PARCEL SHIPPING OPTIONS

100

TABLE OF CONTENTS

CROSSOVER TRUCK BOXES

Multiple sizes and styles, tie downs, application guide

06 - 37

UTILITY CHEST BOXES

Notched, wedged, 5th wheel, under tonneau, trailer tongue, totes

38 - 53

UTV & ATV BOXES

UTV crossover, UTV side mount, ATV tool boxes

54 - 59

SIDE MOUNT BOXES

Topside, truck side, truck fender, underbody, adjustable legs

60 - 69

DRAWER BOXES

Utility chest with drawers, drawer boxes, fender boxes

70 - 75

TRANSFER TANKS

Combo, L-shaped, rectangular, hammerhead-style

76 - 87

DOG BOXES

Northern, southern, one-door, two-door, accessories box

88 - 93

ACCESSORIES

Cargo carrier, tote boxes, replacement parts, heavy-duty packaging

94 - 101

MARKETING SUPPORT

Literature, catalog, banner, retail signage, display stand

102 - 104



Scan QR code for instructions on measuring a truck bed for a tool box or transfer tank



CROSSOVER TRUCK TOOL BOXES

FEATURED PRODUCTS

Scan QR code for current applications or visit uwsta.com



NEW

Crossover box tie downs

Tool box tie-down side rails integrate with your existing tool box to provide a sturdy anchor for additional cargo.



Secure Lock boxes

Secure Lock boxes have unique dual-locking handles for maximum security, as well as a removable BedRug™ liner for easy cleaning.



Lid options

Crossover tool boxes feature our patented RigidCore™ lid and are available in a variety of lid styles, including gull wing and low profile.

PRODUCT INDEX



08

Crossover Box Overview



10

Secure Lock Boxes



12

Pull Handle Boxes



14

Gull Wing Boxes



16

Slim-Line Boxes



18

Extra-Wide Boxes



20

Standard Boxes



21

Tie Downs

CROSSOVER TRUCK TOOL BOXES



Product Details

- Patented RigidCore™ foam-filled lid maximizes strength and prevents binding
- 0.058" extra-thick, one-piece aluminum tub holds heavy tools and cargo
- Stainless steel lock handles for security and corrosion-resistant operation
- Connecting rod allows for convenient operation from driver or passenger side
- Widespread handles are easy to reach from either side of the truck
- Interior rod enclosure helps prevent bending or jamming of lock system
- Lid self-opens for convenient operation and loading (Secure Lock is self-closing)
- Built-in screwdriver holders for easy organization (select models)
- Multiple box sizes available for a custom fit on each truck application
- Easy to install with pre-drilled mounting slots and included hardware
- Multiple styles available, see the product index on page 9 for details

See page 24 for application information



TBS-60

TBS-60-BLK

Finishes & Materials

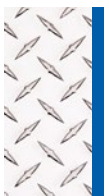

Finish:
Bright
aluminum

Material:
0.058"
aluminum



Finish:
Gloss
black

Material:
0.058"
aluminum



Finish:
Matte
black

Material:
0.058"
aluminum

Strong. Sturdy. Dependable.

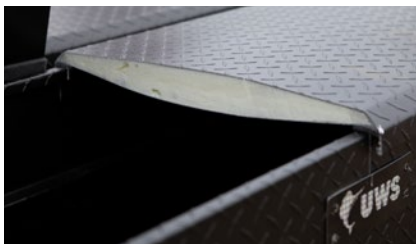

Patented RigidCore foam-filled lid maximizes strength and prevents binding



MicroSeal gasket helps seal out moisture, dust, and dirt



Sliding tray and built-in tool trays for convenient storage and retrieval

CROSSOVER BOX CONFIGURATION OPTIONS

Most boxes are available with a combination of the options listed below.

Profile Options

Standard



Top portion of the tool box overhangs the bed rails to maximize space (pgs 14, 16, 18, 20)

Low



Built lower on the bed rail for a better view out the rear window (pgs 10, 12, 16, 20)

Handle Options

Secure Lock



Easy-to-operate, dual-locking twist handles for strength and security (pg 10)

Pull



Stainless steel handles provide more clearance for easier opening (pg 12)

Paddle



Standard handle type on most of our tool boxes; opens by pulling outward (pgs 14, 16, 18, 20)

Lid Options

Single



Standard lid type for most of our tool boxes; opened facing the truck bed (pgs 10, 12, 16, 18, 20)

Gull Wing



Features two single lids for convenient half-box access (pg 14)

Lid Rail



7/8" lid rail provides a reliable anchor for tying down cargo on top (pgs 10, 20)

Tie Downs



Add-on accessory fits most crossover boxes (pg 21)

Tub Options

Standard



Tub type for most of our tool boxes, featuring a rectangular shape (pgs 10, 12, 14, 16, 18, 20)

Deep

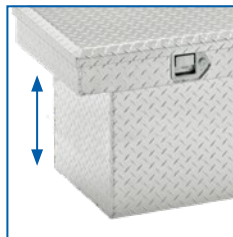

Built extra-tall for max space; available with other tub options (pgs 10, 14, 16, 18, 20)

Angled

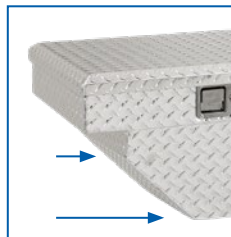

Accommodates unique bed sizes and wheel well shapes (pgs 10, 20)

Slim-Line



Designed for mid-sized trucks with limited space in front of the wheel wells (pg 16)

Extra-Wide



Extra box width provides maximum storage area for tools and equipment (pg 18)

SECURE LOCK CROSSOVER BOXES



Key Features

- Easy-to-operate, dual-locking twist handles offer strength and maximum security
- Removable BedRug™ liner protects tools, reduces noise, and allows for easy cleaning
- See page 8 for a full list of product details

See page 24 for application information



SL-69-LP-MB-R

SL-63-A-LP



SL-72-LP

SLD-69-A-LP-MB

Finishes & Material

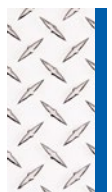

Finish:
Bright
aluminum

Material:
0.058"
aluminum



Finish:
Gloss
black

Material:
0.058"
aluminum



Finish:
Matte
black

Material:
0.058"
aluminum

Scan for current applications
or visit uwsta.com



Removable
BedRug™ liner

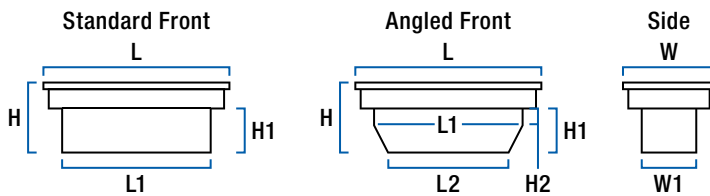

Part #	Profile	Finish	Angled	Rail	Cu. Feet	Dimensions (inches)							
						L	L1	L2	W	W1	H	H1	H2
Standard Tub													
SL-63-A-LP*	Low	Bright alum.	Yes	No	7	64	53	38.75	20	17	14.75	11.75	3.25
SL-63-A-LP-MB*	Low	Matte black	Yes	No	7	64	53	38.75	20	17	14.75	11.75	3.25
SL-69-LP	Low	Bright alum.	No	No	8.4	70	59	--	20	17	14.5	11.75	--
SL-69-LP-BLK	Low	Gloss black	No	No	8.4	70	59	--	20	17	14.5	11.75	--
SL-69-LP-MB	Low	Matte black	No	No	8.4	70	59	--	20	17	14.5	11.75	--
SL-69-LP-R	Low	Bright alum.	No	Yes	8.4	70	59	--	20	17	16.5	11.75	--
SL-69-LP-BLK-R	Low	Gloss black	No	No	8.4	70	59	--	20	17	14.5	11.75	--
SL-69-LP-MB-R	Low	Matte black	No	Yes	8.4	70	59	--	20	17	16.5	11.75	--
SL-72-LP	Low	Bright alum.	No	No	8.6	73	62	--	20	17	14.5	11.75	--
SL-72-LP-BLK	Low	Gloss black	No	No	8.6	73	62	--	20	17	14.5	11.75	--
SL-72-LP-MB	Low	Matte black	No	No	8.6	73	62	--	20	17	14.5	11.75	--
SL-72-LP-R	Low	Bright alum.	No	Yes	8.6	73	62	--	20	17	16.5	11.75	--
SL-72-LP-BLK-R	Low	Gloss black	No	No	8.6	73	62	--	20	17	14.5	11.75	--
SL-72-LP-MB-R	Low	Matte black	No	Yes	8.6	73	62	--	20	17	16.5	11.75	--
Deep Tub													
SLD-69-A-LP*	Low	Bright alum.	Yes	No	10	70	59	46	20	17	18.75	16	4.5
SLD-69-A-LP-MB*	Low	Matte black	Yes	No	10	70	59	46	20	17	18.75	16	4.5
SLD-69-A-LP-BLK*	Low	Gloss Black	Yes	No	10	70	59	46	20	17	18.75	16	4.5
SLD69-A-LP-MB-R*	Low	Matte black	Yes	Yes	10	70	59	46	20	17	20.75	16	4.5

* Built-in screwdriver holder not included

PULL HANDLE CROSSOVER BOXES



Key Features

- Stainless steel pull handles provide more clearance for easier opening
- Built lower on the bed rail for a better view out the rear window
- See page 8 for a full list of product details

See page 24 for application information



Finishes & Material

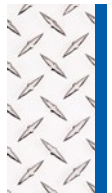

Finish:
Bright aluminum
Material:
0.058" aluminum



Finish:
Gloss black
Material:
0.058" aluminum



Finish:
Matte black
Material:
0.058" aluminum

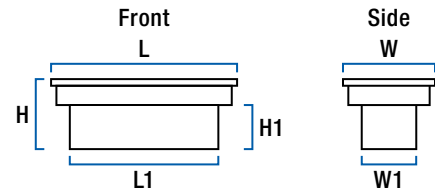

Part #	Profile	Finish	Angled	Rail	Cubic Feet	Dimensions (inches)					
						L	L1	W	W1	H	H1
Standard Tub											
TBS-69-LP-PH	Low	Bright aluminum	No	No	8.4	70	59	20	17	14.5	11.75
TBS-69-LP-PH-B	Low	Gloss black	No	No	8.4	70	59	20	17	14.5	11.75
TBS-69-LP-PH-MB	Low	Matte black	No	No	8.4	70	59	20	17	14.5	11.75
TBS-72-LP-PH	Low	Bright aluminum	No	No	8.6	73	62	20	17	14.5	11.75
TBS-72-LP-PH-B	Low	Gloss black	No	No	8.6	73	62	20	17	14.5	11.75
TBS-72-LP-PH-MB	Low	Matte black	No	No	8.6	73	62	20	17	14.5	11.75

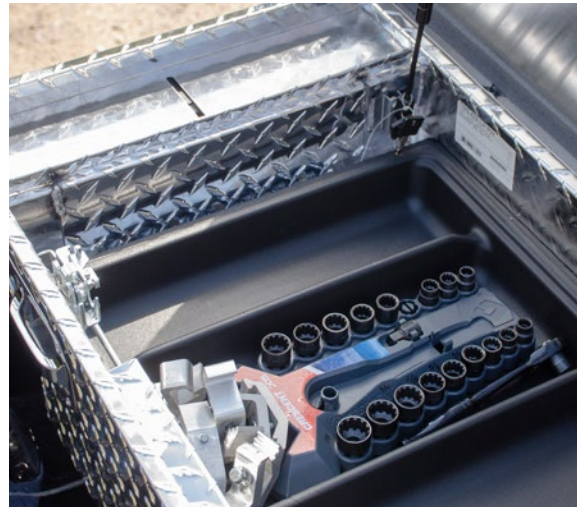

Scan for current applications
or visit uwsta.com



GULL WING CROSSOVER BOXES



Key Features

- Two lids with locking handles provide secure, half-box access
- Patented RigidCore™ foam-filled lid maximizes strength and prevents binding
- See page 8 for a full list of product details

See page 24 for application information

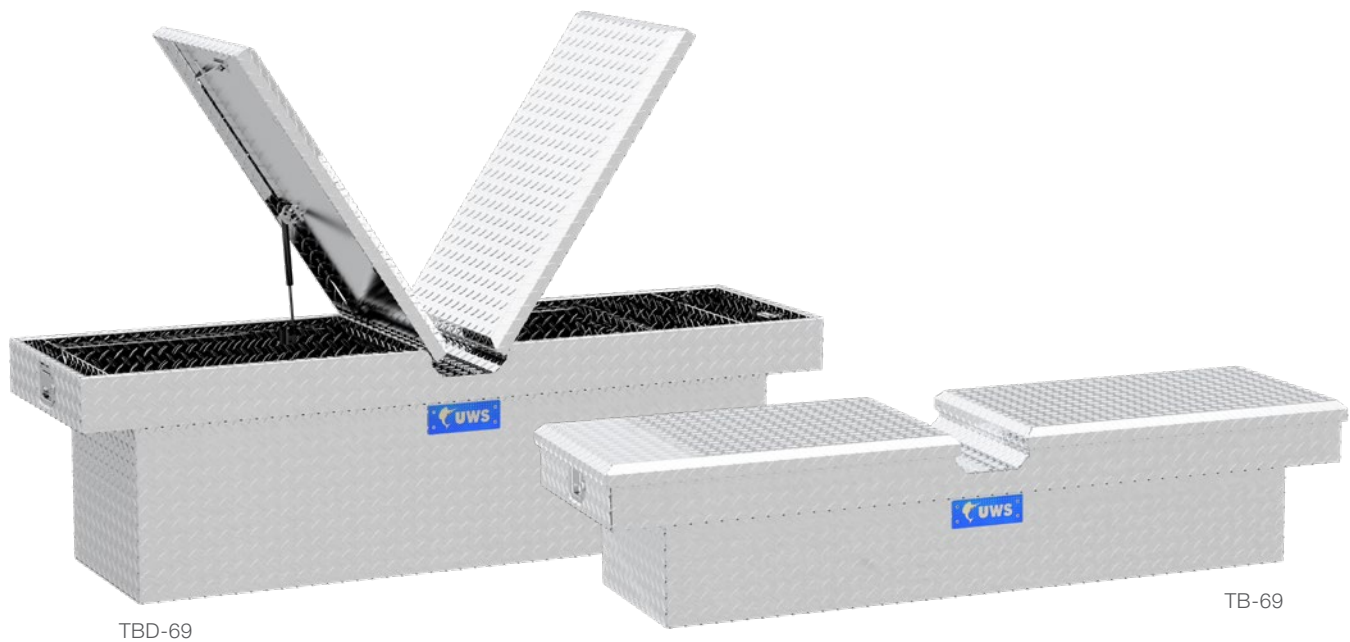

TBD-69

TB-69

Finish & Material



Finish:
Bright aluminum

Material:
0.058" aluminum

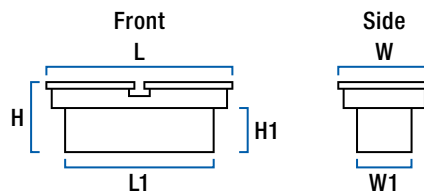

Part #	Profile	Finish	Angled	Rail	Cubic Feet	Dimensions (inches)					
						L	L1	W	W1	H	H1
Standard Tub											
TB-60	Standard	Bright aluminum	No	No	7.3	61	50	20	17	14.75	9
TB-63	Standard	Bright aluminum	No	No	8	64	53	20	17	14.75	9
TB-69	Standard	Bright aluminum	No	No	8.5	70	59	20	17	14.75	9
TB-72	Standard	Bright aluminum	No	No	9	73	62	20	17	14.75	9
Deep Tub											
TBD-69	Standard	Bright aluminum	No	No	12.4	70	59	20	17	20.5	15
TBD-72	Standard	Bright aluminum	No	No	12.7	73	62	20	17	20.5	15



Scan for current applications
or visit uwsta.com



SLIM-LINE CROSSOVER BOXES



Key Features

- Designed for truck beds with limited space in front of the wheel wells
- Patented RigidCore™ foam-filled lid maximizes strength and prevents binding
- See page 8 for a full list of product details

See page 24 for application information

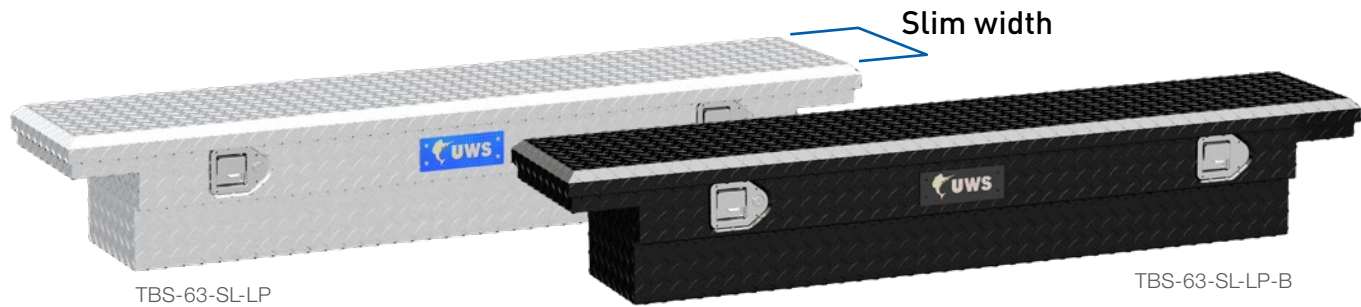

Finishes & Material



Finish:
Bright aluminum
Material:
0.058"
aluminum



Finish:
Gloss black
Material:
0.058"
aluminum

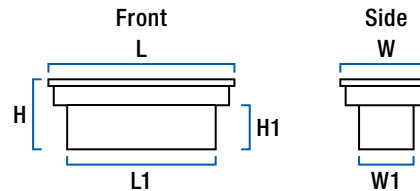

Part #	Profile	Finish	Angled	Rail	Cubic Feet	Dimensions (inches)					
						L	L1	W	W1	H	H1
Standard Tub											
TBS-60-SL	Standard	Bright aluminum	No	No	3.2	61	50	12.75	9.75	10.5	4.75
TBS-60-SL-BLK	Standard	Gloss black	No	No	3.2	61	50	12.75	9.75	10.5	4.75
TBS-63-SL	Standard	Bright aluminum	No	No	3.4	64	53	12.75	9.75	10.5	4.75
TBS-63-SL-LP	Low	Bright aluminum	No	No	5.7	64	53	12.75	9.75	10.5	7.25
TBS-63-SL-BLK	Standard	Gloss black	No	No	3.4	64	53	12.75	9.75	10.5	4.75
TBS-63-SL-LP-B	Low	Gloss black	No	No	5.7	64	53	12.75	9.75	10.5	7.25
TBS-69-SL	Standard	Bright aluminum	No	No	3.8	70	59	12.75	9.75	10.5	4.75
TBS-69-SL-LP	Low	Bright aluminum	No	No	3.5	70	59	12.75	9.75	10.5	7.5
TBS-69-SL-BLK	Standard	Gloss black	No	No	3.8	70	59	12.75	9.75	10.5	4.75
TBS-69-SL-LP-B	Low	Gloss black	No	No	3.5	70	59	12.75	9.75	10.5	7.5
TBS-72-SL	Standard	Bright aluminum	No	No	3.9	73	62	12.75	9.75	10.5	4.75
TBS-72-SL-BLK	Standard	Gloss black	No	No	3.9	73	62	12.75	9.75	10.5	4.75
Deep Tub											
TBSD-69-SL	Standard	Bright aluminum	No	No	6.4	70	59	12.75	9.75	18.5	12.5
TBSD-69-SL-LP	Low	Bright aluminum	No	No	6.1	70	59	12.75	9.75	18.5	15.5
TBSD-69-SL-BLK	Standard	Gloss black	No	No	6.4	70	59	12.75	9.75	18.5	12.5
TBSD-69-SL-LP-B	Low	Gloss black	No	No	6.1	70	59	12.75	9.75	18.5	15.5
TBSD-72-SL-LP	Low	Bright aluminum	No	No	6.5	73	62	12.75	9.75	18.5	15.5
TBSD-72-SL-LP-B	Low	Gloss black	No	No	6.5	73	62	12.75	9.75	18.5	15.5



Scan for current applications
or visit uwsta.com



EXTRA-WIDE CROSSOVER BOXES



Key Features

- Extra box width provides maximum storage area for tools and equipment
- Patented RigidCore™ foam-filled lid maximizes strength and prevents binding
- See page 8 for a full list of product details

See page 24 for application information



Finishes & Material

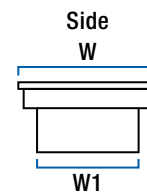
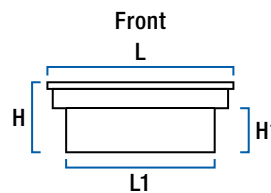
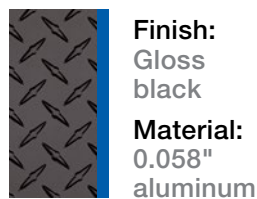
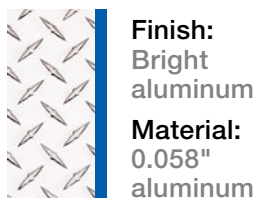

Part #	Profile	Finish	Angled	Rail	Cubic Feet	Dimensions (inches)					
						L	L1	W	W1	H	H1
Standard Tub											
TBS-69-LBTA	Standard	Bright aluminum	No	No	12.2	70	59	28.25	25.25	14	8.5
TBS-69-LBTA-BLK	Standard	Gloss black	No	No	12.2	70	59	28.25	25.25	14	8.5
TBS-72-LBTA	Standard	Bright aluminum	No	No	12.7	73	62	28.25	25.25	14	8.5
TBS-72-LBTA-BLK	Standard	Gloss black	No	No	12.7	73	62	28.25	25.25	14	8.5
Deep Tub											
TBSD-69-LBTA	Standard	Bright aluminum	No	No	16.7	70	59	28.25	25.25	19	13.25
TBSD-69-LBTA-B	Standard	Gloss black	No	No	16.7	70	59	28.25	25.25	19	13.25
TBSD-72-LBTA	Standard	Bright aluminum	No	No	17.1	73	62	28.25	25.25	19	13.25
TBSD-72-LBTA-B	Standard	Gloss black	No	No	17.1	73	62	28.25	25.25	19	13.25



Scan for current applications
or visit uwsta.com



STANDARD CROSSOVER BOXES



Key Features

- Patented RigidCore™ foam-filled lid maximizes strength and prevents binding
- 0.058" extra-thick, one-piece aluminum tub holds heavy tools and cargo
- See page 8 for a full list of product details

See page 22 for products and dimensions

See page 24 for application information



TBSD-60A-BLK



TBS-69-LP-R

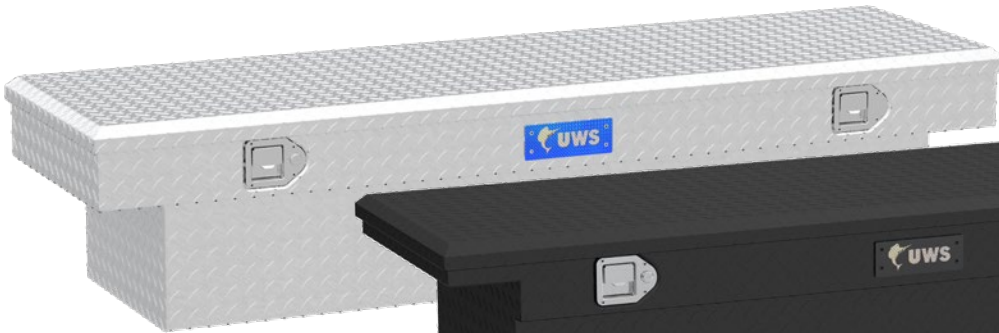

TBS-69



TBS-69-LP-MB

Finishes & Material

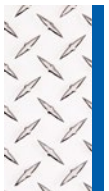

Finish:
Bright
aluminum

Material:
0.058"
aluminum



Finish:
Gloss
black

Material:
0.058"
aluminum



Finish:
Matte
black

Material:
0.058"
aluminum

Scan for current applications
or visit uwsta.com

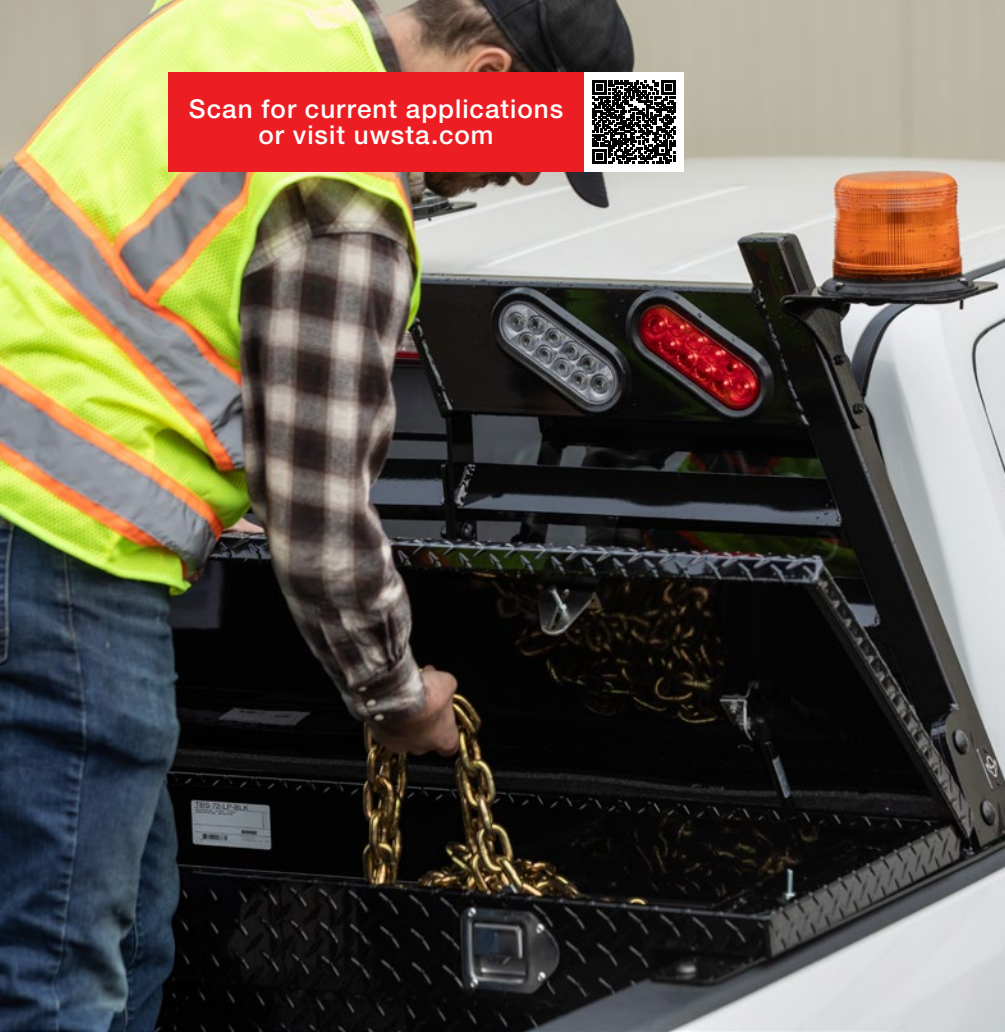

CROSSOVER BOX TIE DOWNS

NEW

Key Features

- Integrated tie-down rails for enhanced cargo management and security
- Robust look and feel to set your truck tool box apart
- Black UV-stabilized, glass-filled nylon construction
- Great add-on upgrade for an existing tool box



UWS-TBTD

Part #	Capacity	Dimensions (inches)		
		L	W	H
UWS-TBTD	50 lbs.	18.125"	2.75"	3.5"



Mounts onto any standard crossover box to provide a stable anchor point to secure cargo

STANDARD CROSSOVER BOXES

See page 24 for application information



TBS-69-MB

TBS-69-LP-A-BLK

TBS-69-LP-R

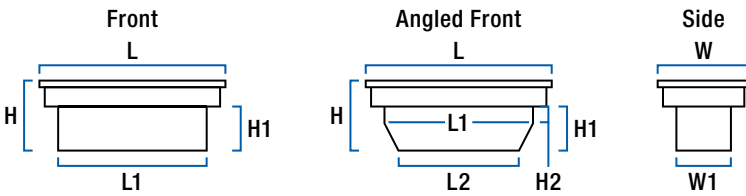

Part #	Profile	Finish	Angled	Rail	Cu. Ft.	Dimensions (inches)							
						L	L1	L2	W	W1	H	H1	H2
Standard Tub													
TBS-54	Standard	Bright alum.	No	No	6.9	55	44	--	20	17	14.75	9	--
TBS-54-LP	Low	Bright alum.	No	No	6.3	55	44	--	20	17	14.75	11.75	--
TBS-54-BLK	Standard	Gloss black	No	No	6.9	55	44	--	20	17	14.75	9	--
TBS-54-LP-BLK	Low	Gloss black	No	No	6.3	55	44	--	20	17	14.75	11.75	--
TBS-58-LP	Low	Bright alum.	No	No	6.6	59	48	--	20	17	14.75	11.75	--
TBS-58-LP-BLK	Low	Gloss black	No	No	6.6	59	48	--	20	17	14.75	11.75	--
TBS-60	Standard	Bright alum.	No	No	7.4	61	50	--	20	17	14.75	9	--
TBS-60-LP	Low	Bright alum.	No	No	7.2	61	50	--	20	17	14.75	11.75	--
TBS-60-BLK	Standard	Gloss black	No	No	7.4	61	50	--	20	17	14.75	9	--
TBS-60-LP-BLK	Low	Gloss black	No	No	7.2	61	50	--	20	17	14.75	11.75	--
TBS-60-A*	Standard	Bright alum.	Yes	No	7	61	50	35.75	20	17	14.75	9	3
TBS-60-A-LP*	Low	Bright alum.	Yes	No	6.6	61	50	35.75	20	17	14.75	11.75	3.25
TBS-60-A-BLK*	Standard	Gloss black	Yes	No	7	61	50	35.75	20	17	14.75	9	3
TBS-60-A-LP-BLK*	Low	Gloss black	Yes	No	6.6	61	50	35.75	20	17	14.75	11.75	3.25
TBS-63-LP	Low	Bright alum.	No	No	7.3	64	53	--	20	17	14.75	11.75	--
TBS-63-BLK	Standard	Gloss black	No	No	7.8	64	53	--	20	17	14.75	9	--
TBS-63-LP-BLK	Low	Gloss black	No	No	7.3	64	53	--	20	17	14.75	11.75	--
TBS-63-A*	Standard	Bright alum.	Yes	No	7.4	64	53	38.75	20	17	14.75	9	3
TBS-63-A-LP*	Low	Bright alum.	Yes	No	7	64	53	38.75	20	17	14.75	11.75	3.25
TBS-63-A-BLK*	Standard	Gloss black	Yes	No	7.4	64	53	38.75	20	17	14.75	9	3
TBS-63-A-LP-BLK*	Low	Gloss black	Yes	No	7	64	53	38.75	20	17	14.75	11.75	3.25
TBS-63-A-LP-MB*	Low	Matte black	Yes	No	7	64	53	38.75	20	17	14.75	11.75	3.25
TBS-66	Standard	Bright alum.	No	No	8.2	67	56	--	20	17	14.75	9	--
TBS-66-LP	Low	Bright alum.	No	No	7.5	67	56	--	20	17	14.75	11.75	--
TBS-66-BLK	Standard	Gloss black	No	No	8.2	67	56	--	20	17	14.75	9	--
TBS-66-LP-BLK	Low	Gloss black	No	No	7.5	67	56	--	20	17	14.75	11.75	--

* Built-in screwdriver holder not included

Part #	Profile	Finish	Angled	Rail	Cu. Ft.	Dimensions (inches)							
						L	L1	L2	W	W1	H	H1	H2
Standard Tub (continued)													
TBS-69	Standard	Bright alum.	No	No	8.6	70	59	--	20	17	14.75	9	--
TBS-69-LP	Low	Bright alum.	No	No	8.4	70	59	--	20	17	14.75	11.75	--
TBS-69-BLK	Standard	Gloss black	No	No	8.6	70	59	--	20	17	14.75	9	--
TBS-69-LP-BLK	Low	Gloss black	No	No	8.4	70	59	--	20	17	14.75	11.75	--
TBS-69-MB	Standard	Matte black	No	No	8.6	70	59	--	20	17	14.75	9	--
TBS-69-LP-MB	Low	Matte black	No	No	8.4	70	59	--	20	17	14.75	11.75	--
TBS-69-A-LP*	Low	Bright alum.	Yes	No	8.3	70	59	48	20	17	14.75	11.75	8.75
TBS-69-A-LP-BLK*	Low	Gloss black	Yes	No	8.3	70	59	48	20	17	14.75	11.75	8.75
TBS-69-LBTA	Standard	Bright alum.	No	No	12.2	70	59	--	28.25	25.25	14	8.5	--
TBS-69-LBTA-BLK	Standard	Gloss black	No	No	12.2	70	59	--	28.25	25.25	14	8.5	--
TBS-69-R	Standard	Bright alum.	No	Yes	8.6	70	59	--	20	17	14.75	9	--
TBS-69-LP-R	Low	Bright alum.	No	Yes	8.4	70	59	20	17	16.75	11.75		--
TBS-72	Standard	Bright alum.	No	No	9	73	62	--	20	17	14.75	9	--
TBS-72-LP	Low	Bright alum.	No	No	8.6	73	62	--	20	17	14.75	11.75	--
TBS-72-BLK	Standard	Gloss black	No	No	9	73	62	--	20	17	14.75	9	--
TBS-72-LP-BLK	Low	Gloss black	No	No	8.6	73	62	--	20	17	14.75	11.75	--
TBS-72-MB	Standard	Matte black	No	No	9	73	62	--	20	17	14.75	9	--
TBS-72-LP-MB	Low	Matte black	No	No	8.6	73	62	--	20	17	14.75	11.75	--
TBS-72-LBTA	Standard	Bright alum.	No	No	12.7	73	62	--	28.25	25.25	14	8.5	--
TBS-72-LBTA-BLK	Standard	Gloss black	No	No	12.7	73	62	--	28.25	25.25	14	8.5	--
TBS-72-R	Standard	Bright alum.	No	Yes	9	73	62	--	20	17	14.75	9	--
Deep Tub													
TBSD-60A*	Standard	Bright alum.	Yes	No	7.5	61	50	38	20	17	20.75	15	--
TBSD-60A-LP	Low	Bright alum.	Yes	No	6.3	61	50	35.75	20	17	17.75	14.875	3
TBSD-60A-BLK*	Standard	Gloss black	Yes	No	7.5	61	50	38	20	17	20.75	15	--
TBSD-60A-LP-BLK	Low	Gloss black	Yes	No	6.3	61	50	35.75	20	17	17.75	14.875	3
TBSD-63A*	Standard	Bright alum.	Yes	No	7.7	64	53	40	20	17	20.75	16	--
TBSD-63A-LP*	Low	Bright alum.	Yes	No	6.8	64	53	36	20	17	17.75	16	3
TBSD-63A-BLK*	Standard	Gloss black	Yes	No	7.7	64	53	40	20	17	20.75	15	--
TBSD-63A-LP-BLK*	Low	Gloss black	Yes	No	6.8	64	53	36	20	17	17.75	14.875	3
TBSD-69	Standard	Bright alum.	No	No	12.4	70	59	--	20	17	20.75	15	--
TBSD-69-LP	Low	Bright alum.	No	No	10.8	70	59	--	20	17	18.75	16	--
TBSD-69-BLK	Standard	Gloss black	No	No	12.4	70	59	--	20	17	20.75	15	--
TBSD-69-LP-BLK	Low	Gloss black	No	No	10.8	70	59	--	20	17	18.75	16	--
TBSD-69-A	Standard	Bright alum.	Yes	No	10.2	70	59	46	20	17	20.75	15	3.75
TBSD-69-A-LP*	Low	Bright alum.	Yes	No	10	70	59	46	20	17	18.75	16	4.75
TBSD-69-A-BLK	Standard	Gloss black	Yes	No	10.2	70	59	46	20	17	20.75	15	3.75
TBSD-69-A-LP-B*	Low	Gloss black	Yes	No	10	70	59	46	20	17	18.75	16	4.75
TBSD-69-A-MB	Standard	Matte black	Yes	No	10.2	70	59	46	20	17	20.75	15	3.75
TBSD-69-A-LP-MB*	Low	Matte black	Yes	No	10	70	59	46	20	17	18.75	16	4.75
TBSD-69-LBTA	Standard	Bright alum.	No	No	16.7	70	59	--	28.25	25.25	19	13.25	--
TBSD-69-LBTA-B	Standard	Gloss black	No	No	16.7	70	59	--	28.25	25.25	19	13.25	--
TBSD-72-A	Standard	Bright alum.	Yes	No	12.6	73	62	56	20	17	20.75	15	12
TBSD-72-A-LP	Low	Bright alum.	Yes	No	11.2	73	62	56	20	17	18.75	16	12.75
TBSD-72-A-BLK	Standard	Gloss black	Yes	No	12.6	73	62	56	20	17	20.75	15	12
TBSD-72-A-LP-B	Low	Gloss black	Yes	No	11.2	73	62	56	20	17	18.75	16	12.75
TBSD-72-LBTA	Standard	Bright alum.	No	No	17.1	73	62	--	28.25	25.25	19	13.25	--
TBSD-72-LBTA-B	Standard	Gloss black	No	No	17.1	73	62	--	28.25	25.25	19	13.25	--

* Built-in screwdriver holder not included



Available ordering options
(listed above part numbers)

All part #s listed are Bright Aluminum. Use key below to identify alternative finishes or to add a rail. Then add desired suffix shown to end of part #.

A - Matte Black (add **-MB**)
B - Aluminum with Rail (add **-R**)
C - Matte Black with Rail (add **-MB-R**)
D - Gloss Black (add **-BLK**)
E - Gloss Black with Rail (add **-BLK-R**)

Secure Lock	Pull Hdle		Gull Wing				Slim Line				
	Standard		D		Std		Standard		Deep		
	A	A,B,C,D,E	A,B,C,D,E	A,C,T,D	A,D*	A,D*	--	--	--	--	Standard

Make / Model	Cab Length	Years	Bed Style	Bed Leng.	Foot Note	SL-63-A-LP	SL-69-LP	SL-72-LP	SLD-69-A-LP	TBS-69-LP-PH	TBS-72-LP-PH	TB-60	TB-63	TB-69	TB-72	TBD-69	TBD-72	TBS-60-SL	TBS-63-SL	TBS-63-SL-LP	TBS-69-SL	TBS-69-SL-LP	TBS-72-SL	TBSD-69-SL	TBSD-69-SL-LP	TBSD-72-SL-LP		
Chevrolet																												
Colorado	Crew	23 - 25	Fleetside	5'	--	--	--	--	--	--	--	●	--	--	--	--	--	●	--	--	--	--	--	--	--	--	--	
		19 - 22	Fleetside	5'	--	●	--	--	--	--	--	--	●	--	--	--	--	--	--	●	●	--	--	--	--	--	--	--
		15 - 18	Fleetside	5' 6"	--	●	--	--	--	--	--	--	●	--	--	--	--	--	--	●	●	--	--	--	--	--	--	--
		15 - 18	Fleetside	6'	--	●	--	--	--	--	--	--	●	--	--	--	--	--	--	●	●	--	--	--	--	--	--	--
		04 - 12	Styleside	5' 5"	--	--	--	--	--	--	--	--	--	--	--	--	--	--	--	--	--	--	--	--	--	--	--	--
	04 - 12	Styleside	6'	--	--	--	--	--	--	--	--	--	--	--	--	--	--	--	--	--	--	--	--	--	--	--	--	
Extended	15 - 18	Fleetside	6'	--	--	--	--	--	--	--	--	●	--	--	--	--	--	--	●	●	--	--	--	--	--	--	--	
	04 - 12	Fleetside	6'	--	--	--	--	--	--	--	--	--	--	--	--	--	--	--	--	--	--	--	--	--	--	--	--	
Standard	04 - 12	Styleside	6'	--	--	--	--	--	--	--	--	--	--	--	--	--	--	--	--	--	--	--	--	--	--	--	--	
	04 - 12	Styleside	6'	--	--	--	--	--	--	--	--	--	--	--	--	--	--	--	--	--	--	--	--	--	--	--	--	
S10	Crew	01 - 04	Fleetside	4' 8"	--	--	--	--	--	--	--	●	--	--	--	--	--	--	●	--	--	--	--	--	--	--	--	
		94 - 03	Fleetside	6'	--	--	--	--	--	--	--	--	●	--	--	--	--	--	●	--	--	--	--	--	--	--	--	--
		96 - 03	Stepside	6'	--	--	--	--	--	--	--	--	●	--	--	--	--	--	--	●	--	--	--	--	--	--	--	--
		94 - 03	Fleetside	7' 6"	--	--	--	--	--	--	--	--	●	--	--	--	--	--	--	●	--	--	--	--	--	--	--	--
Silverado 1500	Crew	14 - 25	Fleetside	5' 8"	--	--	●	--	●	●	--	--	●	--	--	●	--	--	--	--	●	●	--	●	●	--	--	
		14 - 25	Fleetside	6' 6"	--	--	●	--	●	●	--	--	●	--	--	●	--	--	--	--	●	●	--	●	●	--	--	--
		07 - 13	Fleetside	5' 8"	--	--	●	--	●	●	--	--	●	--	--	●	--	--	--	--	●	●	--	●	●	--	--	--
		04 - 06	Fleetside	8'	--	--	●	--	●	●	--	--	●	--	--	●	--	--	--	--	●	●	--	●	●	--	--	--
	Extended	14 - 25	Fleetside	6' 6"	--	--	●	--	●	●	--	--	●	--	--	●	--	--	--	--	●	●	--	●	●	--	--	--
		07 - 13	Fleetside	6' 6"	--	--	●	--	●	●	--	--	●	--	--	●	--	--	--	--	●	●	--	●	●	--	--	--
		07 - 13	Fleetside	8'	--	--	●	--	●	●	--	--	●	--	--	●	--	--	--	--	●	●	--	●	●	--	--	--
		99 - 05	Stepside	6' 6"	--	--	●	--	●	●	--	--	●	--	--	●	--	--	--	--	●	●	--	●	●	--	--	--
	Standard	99 - 06	Fleetside	6' 6"	--	--	●	--	●	●	--	--	●	--	--	●	--	--	--	--	●	●	--	●	●	--	--	--
		99 - 06	Fleetside	8'	--	--	●	--	●	●	--	--	●	--	--	●	--	--	--	--	●	●	--	●	●	--	--	--
		14 - 25	Fleetside	6' 6"	--	--	●	--	●	●	--	--	●	--	--	●	--	--	--	--	●	●	--	●	●	--	--	--
		14 - 25	Fleetside	8'	--	--	●	--	●	●	--	--	●	--	--	●	--	--	--	--	●	●	--	●	●	--	--	--
		07 - 13	Fleetside	6' 6"	--	--	●	--	●	●	--	--	●	--	--	●	--	--	--	--	●	●	--	●	●	--	--	--
		07 - 13	Fleetside	8'	--	--	●	--	●	●	--	--	●	--	--	●	--	--	--	--	●	●	--	●	●	--	--	--
Silverado 1500 Classic	Crew	07 - 07	Fleetside	5' 8.5"	--	--	●	--	●	●	--	--	●	--	--	●	--	--	--	●	●	--	●	●	--	--	--	
		07 - 07	Fleetside	8'	--	--	●	--	●	●	--	--	●	--	--	●	--	--	--	●	●	--	●	●	--	--	--	
	Extended	07 - 07	Fleetside	6' 6"	--	--	●	--	●	●	--	--	●	--	--	●	--	--	--	●	●	--	●	●	--	--	--	--
		07 - 07	Fleetside	8'	--	--	●	--	●	●	--	--	●	--	--	●	--	--	--	●	●	--	●	●	--	--	--	--
	Standard	07 - 07	Fleetside	6' 6"	--	--	●	--	●	●	--	--	●	--	--	●	--	--	--	●	●	--	●	●	--	--	--	--
		07 - 07	Fleetside	8'	--	--	●	--	●	●	--	--	●	--	--	●	--	--	--	●	●	--	●	●	--	--	--	--
Silverado 1500 LD	Extended	19 - 19	Fleetside	6' 6"	--	--	●	--	●	●	--	--	●	--	●	--	--	--	●	●	--	●	●	--	--	--	--	
Silverado 1500 LTD	Crew	22 - 22	Fleetside	5' 8"	--	--	●	--	●	●	--	--	●	--	--	●	--	--	--	●	●	--	●	●	--	--	--	
		22 - 22	Fleetside	6' 6"	--	--	●	--	●	●	--	--	●	--	--	●	--	--	--	●	●	--	●	●	--	--	--	
	Extended Standard	22 - 22	Fleetside	6' 6"	--	--	●	--	●	●	--	--	●	--	--	●	--	--	--	●	●	--	●	●	--	--	--	
Silverado 2500	Crew	04 - 04	Fleetside	8'	--	--	●	--	●	●	--	--	●	--	--	●	--	--	--	●	●	--	●	●	--	--	--	
		99 - 04	Fleetside	6' 6"	--	--	●	--	●	●	--	--	●	--	--	●	--	--	--	●	●	--	●	●	--	--	--	
	Standard	99 - 04	Fleetside	8'	--	--	●	--	●	●	--	--	●	--	--	●	--	--	--	●	●	--	●	●	--	--	--	
		99 - 04	Fleetside	6' 6"	--	--	●	--	●	●	--	--	●	--	--	●	--	--	--	●	●	--	●	●	--	--	--	

Footnotes	For the most up-to-date application information please visit uwsta.com
1 If your model is equipped with a factory, hard-plastic tonneau system covering the bed rail, a crossover tool box will not fit.	3 If your model is equipped with a factory track-system, standard box-mounting may not apply.
2 If your model is equipped with a Ram Box, a crossover tool box will not fit.	4 If your model is equipped with a factory bed-rail system, standard box-mounting may not apply.
	* For Gloss Black, add -B instead of -BLK
	† For Matte Black with rail, use part# SLD69-A-LP-MB-R



Available ordering options
(listed above part numbers)

All part #s listed are Bright Aluminum. Use key below to identify alternative finishes or to add a rail. Then add desired suffix shown to end of part #.

A - Matte Black (add **-MB**)
B - Aluminum with Rail (add **-R**)
C - Matte Black with Rail (add **-MB-R**)
D - Gloss Black (add **-BLK**)
E - Gloss Black with Rail (add **-BLK-R**)

Secure Lock	Pull Hdle		Gull Wing				Slim Line													
	Standard	D	Std	Standard		Deep		Standard			Deep									
	A	A,B,C,D,E	A,B,C,D,E	A,C†,D	A,D*	A,D*	--	--	--	--	--	D	D	D	D	D	D	D	D	
SL-63-A-LP	SL-69-LP	SL-72-LP	SLD-69-A-LP	TBS-69-LP-PH	TBS-72-LP-PH	TB-60	TB-63	TB-69	TB-72	TBD-69	TBD-72	TBS-60-SL	TBS-63-SL	TBS-63-SL-LP	TBS-69-SL	TBS-69-SL-LP	TBS-72-SL	TBSD-69-SL	TBSD-69-SL-LP	TBSD-72-SL-LP

Make / Model	Cab Length	Years	Bed Style	Bed Leng.	Foot Note	SL-63-A-LP	SL-69-LP	SL-72-LP	SLD-69-A-LP	TBS-69-LP-PH	TBS-72-LP-PH	TB-60	TB-63	TB-69	TB-72	TBD-69	TBD-72	TBS-60-SL	TBS-63-SL	TBS-63-SL-LP	TBS-69-SL	TBS-69-SL-LP	TBS-72-SL	TBSD-69-SL	TBSD-69-SL-LP	TBSD-72-SL-LP		
Chevrolet (continued)																												
Silverado 2500 HD	Crew	20 - 25	Fleetside	7'	--	--	●	--	●	●	--	--	--	●	--	●	--	--	--	--	●	●	--	●	●	--	●	
		20 - 25	Fleetside	8'	--	--	●	--	●	●	--	--	--	●	--	●	--	--	--	--	--	●	●	--	●	●	--	●
		15 - 19	Fleetside	6' 6"	--	--	●	--	●	●	--	--	--	●	--	●	--	--	--	--	--	●	●	--	●	●	--	●
		15 - 19	Fleetside	8'	--	--	●	--	●	●	--	--	--	●	--	●	--	--	--	--	--	●	●	--	●	●	--	●
	Extended	01 - 06	Fleetside	8'	--	--	●	--	●	●	--	--	--	●	--	●	--	--	--	--	--	●	●	--	●	●	--	●
		01 - 19	Fleetside	6' 6"	--	--	●	--	●	●	--	--	--	●	--	●	--	--	--	--	--	●	●	--	●	●	--	●
	Standard	01 - 25	Fleetside	7'	--	--	●	--	●	●	--	--	--	●	--	●	--	--	--	--	--	●	●	--	●	●	--	●
		01 - 25	Fleetside	8'	--	--	●	--	●	●	--	--	--	●	--	●	--	--	--	--	--	●	●	--	●	●	--	●
Silverado 2500 HD Classic	Crew	07 - 07	Fleetside	8'	--	--	●	--	●	●	--	--	--	●	--	●	--	--	--	--	●	●	--	●	●	--	●	
		07 - 07	Fleetside	6' 6"	--	--	●	--	●	●	--	--	--	●	--	●	--	--	--	--	●	●	--	●	●	--	●	
	Standard	07 - 07	Fleetside	6' 6"	--	--	●	--	●	●	--	--	--	●	--	●	--	--	--	--	--	●	●	--	●	●	--	●
		07 - 07	Fleetside	8'	--	--	●	--	●	●	--	--	--	●	--	●	--	--	--	--	--	●	●	--	●	●	--	●
Silverado 3500	Crew	01 - 06	Fleetside	8'	--	--	●	--	●	●	--	--	--	●	--	●	--	--	--	--	●	●	--	●	●	--	●	
	Extended	01 - 06	Fleetside	8'	--	--	●	--	●	●	--	--	--	●	--	●	--	--	--	--	●	●	--	●	●	--	●	
	Standard	01 - 06	Fleetside	8'	--	--	●	--	●	●	--	--	--	●	--	●	--	--	--	--	●	●	--	●	●	--	●	
Silverado 3500 Classic	Crew	07 - 07	Fleetside	8'	--	--	●	--	●	●	--	--	--	●	--	●	--	--	--	--	●	●	--	●	●	--	●	
	Extended	07 - 07	Fleetside	8'	--	--	●	--	●	●	--	--	--	●	--	●	--	--	--	--	●	●	--	●	●	--	●	
	Standard	07 - 07	Fleetside	8'	--	--	●	--	●	●	--	--	--	●	--	●	--	--	--	--	●	●	--	●	●	--	●	
Silverado 3500 HD	Crew	20 - 25	Fleetside	7'	--	--	●	--	●	●	--	--	--	●	--	●	--	--	--	--	●	●	--	●	●	--	●	
		20 - 25	Fleetside	8'	--	--	●	--	●	●	--	--	--	●	--	●	--	--	--	--	●	●	--	●	●	--	●	
		15 - 19	Fleetside	6' 6"	--	--	●	--	●	●	--	--	--	●	--	●	--	--	--	--	--	●	●	--	●	●	--	●
		15 - 19	Fleetside	8'	--	--	●	--	●	●	--	--	--	●	--	●	--	--	--	--	--	●	●	--	●	●	--	●
	Extended	11 - 19	Fleetside	6' 6"	--	--	●	--	●	●	--	--	--	●	--	●	--	--	--	--	--	●	●	--	●	●	--	●
		07 - 25	Fleetside	8'	--	--	●	--	●	●	--	--	--	●	--	●	--	--	--	--	--	●	●	--	●	●	--	●
	Standard	07 - 25	Fleetside	8'	--	--	●	--	●	●	--	--	--	●	--	●	--	--	--	--	--	●	●	--	●	●	--	●
Dodge																												
Dakota	Extended	09 - 10	Fleetside	5' 6"	--	--	--	--	--	--	--	--	--	--	--	--	--	--	--	●	●	--	--	--	--	--	--	
		00 - 04	Fleetside	5' 6"	--	--	--	--	--	--	--	--	--	--	--	--	--	--	--	--	●	●	--	--	--	--	--	--
		97 - 04	Fleetside	6' 6"	--	●	--	--	--	--	--	--	--	●	--	--	--	--	--	--	●	●	--	--	--	--	--	--
	Standard	00 - 04	Fleetside	5' 6"	--	●	--	--	--	--	--	--	--	--	--	--	--	--	--	--	●	●	--	--	--	--	--	--
97 - 04		Fleetside	6' 6"	--	●	--	--	--	--	--	--	--	●	--	--	--	--	--	--	●	●	--	--	--	--	--	--	
Ram 1500	Crew	09 - 10	Fleetside	5' 7"	--	--	--	--	--	--	--	--	--	--	●	--	--	--	--	--	●	●	--	--	--	--	--	
		09 - 10	Fleetside	6' 4"	2	--	●	--	--	●	--	--	--	●	--	●	--	--	--	--	●	●	--	●	●	--	●	
		09 - 10	Fleetside	8'	--	--	●	--	--	●	--	--	--	●	--	●	--	--	--	--	●	●	--	●	●	--	●	
	Extended	09 - 10	Fleetside	5' 7"	--	--	--	--	--	--	--	--	--	●	--	●	--	--	--	--	--	●	●	--	●	●	--	●
		09 - 10	Fleetside	6' 4"	2	--	●	--	--	●	--	--	--	●	--	●	--	--	--	--	--	●	●	--	●	●	--	●
		09 - 10	Fleetside	8'	--	--	●	--	--	●	--	--	--	●	--	●	--	--	--	--	--	●	●	--	●	●	--	●
	Extended Crew	06 - 08	Fleetside	6' 6"	--	--	●	--	--	●	--	--	--	●	--	●	--	--	--	--	--	●	●	--	●	●	--	●
		06 - 08	Fleetside	8'	--	--	●	--	--	●	--	--	--	●	--	●	--	--	--	--	--	●	●	--	●	●	--	●
	Standard	09 - 10	Fleetside	5' 7"	--	--	--	--	--	--	--	--	--	●	--	●	--	--	--	--	--	●	●	--	●	●	--	●
		09 - 10	Fleetside	6' 4"	2	--	●	--	--	●	--	--	--	●	--	●	--	--	--	--	--	●	●	--	●	●	--	●
09 - 10		Fleetside	8'	--	--	●	--	--	●	--	--	--	●	--	●	--	--	--	--	--	●	●	--	●	●	--	●	
02 - 08		Fleetside	6' 6"	--	--	●	--	--	●	--	--	--	●	--	●	--	--	--	--	--	●	●	--	●	●	--	●	
02 - 08	Fleetside	8'	--	--	●	--	--	●	--	--	--	●	--	●	--	--	--	--	--	●	●	--	●	●	--	●		

Footnotes	For the most up-to-date application information please visit uwsta.com	
1 If your model is equipped with a factory, hard-plastic tonneau system covering the bed rail, a crossover tool box will not fit.	3 If your model is equipped with a factory track-system, standard box-mounting may not apply.	* For Gloss Black, add -B instead of -BLK
2 If your model is equipped with a Ram Box, a crossover tool box will not fit.	4 If your model is equipped with a factory bed-rail system, standard box-mounting may not apply.	† For Matte Black with rail, use part# SLD69-A-LP-MB-R



Available ordering options
(listed above part numbers)

All part #s listed are Bright Aluminum. Use key below to identify alternative finishes or to add a rail. Then add desired suffix shown to end of part #.

A - Matte Black (add **-MB**)
B - Aluminum with Rail (add **-R**)
C - Matte Black with Rail (add **-MB-R**)
D - Gloss Black (add **-BLK**)
E - Gloss Black with Rail (add **-BLK-R**)

Make / Model	Cab Length	Years	Bed Style	Bed Leng.	Foot Note	Secure Lock			Pull Hdle		Gull Wing		Slim Line									
						Standard		D	Std	Standard		Deep	Standard		Deep							
						A	A,B,C,D,E	A,B,C,D,E	A,C,T,D	A,D*	A,D*	--	--	--	--	D	D	D	D	D	D	D
SL-63-A-LP	SL-69-LP	SL-72-LP	SLD-69-A-LP	TBS-69-LP-PH	TBS-72-LP-PH	TB-60	TB-63	TB-69	TB-72	TBD-69	TBD-72	TBS-60-SL	TBS-63-SL	TBS-63-SL-LP	TBS-69-SL	TBS-69-SL-LP	TBS-72-SL	TBSD-69-SL	TBSD-69-SL-LP	TBSD-72-SL-LP		
Dodge (continued)																						
Ram 2500	Crew	03 - 08	Fleetside	6' 6"	--	--	--	●	--	--	●	--	--	--	●	--	--	--	●	--	●	
		03 - 08	Fleetside	8'	--	--	--	●	--	--	●	--	--	--	●	--	--	--	●	--	●	
	Extended Crew	06 - 08	Fleetside	6' 6"	--	--	--	●	--	--	●	--	--	--	●	--	--	--	●	--	●	
		06 - 08	Fleetside	8'	--	--	--	●	--	--	●	--	--	--	●	--	--	--	●	--	●	
Standard	03 - 08	Fleetside	6' 6"	--	--	--	●	--	--	●	--	--	--	●	--	--	--	●	--	●		
	03 - 08	Fleetside	8'	--	--	--	●	--	--	●	--	--	--	●	--	--	--	●	--	●		
Ram 3500	Crew	03 - 08	Fleetside	6' 6"	--	--	--	●	--	--	●	--	--	--	●	--	--	--	●	--	●	
		03 - 08	Fleetside	8'	--	--	--	●	--	--	●	--	--	--	●	--	--	--	●	--	●	
	Extended Crew	06 - 08	Fleetside	6' 6"	--	--	--	●	--	--	●	--	--	--	●	--	--	--	●	--	●	
		06 - 08	Fleetside	8'	--	--	--	●	--	--	●	--	--	--	●	--	--	--	●	--	●	
Standard	03 - 08	Fleetside	6' 6"	--	--	--	●	--	--	●	--	--	--	●	--	--	--	●	--	●		
	03 - 08	Fleetside	8'	--	--	--	●	--	--	●	--	--	--	●	--	--	--	●	--	●		
Ford																						
Explorer Sport Trac	--	07 - 10	Styleside	4' 6"	--	--	--	--	--	--	--	--	--	--	--	--	--	--	--	--	--	
		01 - 05	Styleside	4' 6"	--	●	--	--	--	--	●	--	--	●	--	--	--	●	--	●	--	
F-150	Crew	15 - 24	Styleside	5' 6"	--	--	●	--	●	--	--	●	--	●	--	--	●	●	--	●	●	
		15 - 24	Styleside	6' 6"	--	--	●	--	●	--	--	●	--	●	--	--	●	●	--	●	●	
		09 - 14	Styleside	5' 6"	--	--	●	--	●	--	--	●	--	●	--	--	●	●	--	●	●	
		09 - 14	Styleside	6' 6"	--	--	●	--	●	--	--	●	--	●	--	--	●	●	--	●	●	
		04 - 08	Styleside	5' 6"	--	--	--	--	●	--	--	●	--	●	--	--	●	●	--	●	●	
		01 - 03	Styleside	5'	--	--	--	●	--	--	●	--	●	--	●	--	●	●	--	●	●	
		01 - 03	Styleside	6' 6"	--	--	●	--	●	--	--	●	--	●	--	●	●	--	●	●	●	
		01 - 08	Styleside	8'	--	--	●	--	●	--	--	●	--	●	--	●	●	--	●	●	●	
		Extended	15 - 24	Styleside	6' 6"	--	--	●	--	●	--	--	●	--	●	--	--	●	●	--	●	●
			15 - 24	Styleside	8'	--	--	●	--	●	--	--	●	--	●	--	--	●	●	--	●	●
	09 - 14		Styleside	6' 6"	--	--	●	--	●	--	--	●	--	●	--	--	●	●	--	●	●	
	04 - 08		Styleside	6' 6"	--	--	●	--	●	--	--	●	--	●	--	--	●	●	--	●	●	
	04 - 08		Flareside	6' 6"	--	--	--	●	--	--	●	--	●	--	●	--	●	●	--	●	●	
	04 - 08		Styleside	8'	--	--	●	--	●	--	--	●	--	●	--	●	●	--	●	●	●	
	97 - 03		Styleside	6' 6"	--	--	●	--	●	--	--	●	--	●	--	●	●	--	●	●	●	
	97 - 03		Flareside	6' 6"	--	--	--	●	--	--	●	--	●	--	●	--	●	●	--	●	●	
	97 - 03		Styleside	8'	--	--	●	--	●	--	--	●	--	●	--	●	●	--	●	●	●	
	Standard		15 - 24	Styleside	6' 6"	--	--	●	--	●	--	--	●	--	●	--	--	●	●	--	●	●
		15 - 24	Styleside	8'	--	--	●	--	●	--	--	●	--	●	--	--	●	●	--	●	●	
		09 - 14	Styleside	6' 6"	--	--	●	--	●	--	--	●	--	●	--	--	●	●	--	●	●	
09 - 14		Styleside	8'	--	--	●	--	●	--	--	●	--	●	--	--	●	●	--	●	●		
04 - 08		Flareside	6' 6"	--	--	--	●	--	--	●	--	●	--	●	--	●	●	--	●	●		
04 - 08		Styleside	5' 6"	--	--	--	●	--	--	●	--	●	--	●	--	●	●	--	●	●		
04 - 08		Styleside	8'	--	--	●	--	●	--	--	●	--	●	--	●	●	--	●	●	●		
97 - 03		Styleside	6' 6"	--	--	●	--	●	--	--	●	--	●	--	●	●	--	●	●	●		
97 - 03		Flareside	6' 6"	--	--	--	●	--	--	●	--	●	--	●	--	●	●	--	●	●		
97 - 03		Styleside	8'	--	--	●	--	●	--	--	●	--	●	--	●	●	--	●	●	●		
F-150 Heritage	Extended	04 - 04	Styleside	6' 6"	--	--	●	--	●	--	--	●	--	●	--	--	●	●	--	●	●	
		04 - 04	Styleside	8'	--	--	●	--	●	--	--	●	--	●	--	--	●	●	--	●	●	
	Standard	04 - 04	Styleside	6' 6"	--	--	●	--	●	--	--	●	--	●	--	--	●	●	--	●	●	
		04 - 04	Flareside	6' 6"	--	--	--	●	--	--	●	--	●	--	●	--	●	●	--	●	●	
		04 - 04	Styleside	8'	--	--	●	--	●	--	●	--	●	--	--	●	●	--	●	●		

Footnotes	For the most up-to-date application information please visit uwsta.com	
1 If your model is equipped with a factory, hard-plastic tonneau system covering the bed rail, a crossover tool box will not fit.	3 If your model is equipped with a factory track-system, standard box-mounting may not apply.	* For Gloss Black, add -B instead of -BLK
2 If your model is equipped with a Ram Box, a crossover tool box will not fit.	4 If your model is equipped with a factory bed-rail system, standard box-mounting may not apply.	† For Matte Black with rail, use part# SLD69-A-LP-MB-R



Available ordering options
(listed above part numbers)

All part #s listed are Bright Aluminum. Use key below to identify alternative finishes or to add a rail. Then add desired suffix shown to end of part #.

A - Matte Black (add **-MB**)
B - Aluminum with Rail (add **-R**)
C - Matte Black with Rail (add **-MB-R**)
D - Gloss Black (add **-BLK**)
E - Gloss Black with Rail (add **-BLK-R**)

Standard	D	Std	Gull Wing				Slim Line													
			Standard		Deep		Standard		Deep											
			A	A,B,C,D,E	A,B,C,D,E	A,C,T,D	A,D*	A,D*	D	D	D	D								
SL-63-A-LP	SL-69-LP	SL-72-LP	SLD-69-A-LP	TBS-69-LP-PH	TBS-72-LP-PH	TB-60	TB-63	TB-69	TB-72	TBD-69	TBD-72	TBS-60-SL	TBS-63-SL	TBS-63-SL-LP	TBS-69-SL	TBS-69-SL-LP	TBS-72-SL	TBSD-69-SL	TBSD-69-SL-LP	TBSD-72-SL-LP

Make / Model	Cab Length	Years	Bed Style	Bed Leng.	Foot Note	SL-63-A-LP	SL-69-LP	SL-72-LP	SLD-69-A-LP	TBS-69-LP-PH	TBS-72-LP-PH	TB-60	TB-63	TB-69	TB-72	TBD-69	TBD-72	TBS-60-SL	TBS-63-SL	TBS-63-SL-LP	TBS-69-SL	TBS-69-SL-LP	TBS-72-SL	TBSD-69-SL	TBSD-69-SL-LP	TBSD-72-SL-LP	
Ford (continued)																											
F-250 / F-350 Super Duty	Crew	17 - 25	Styleside	8'	--	--	--	●	--	--	●	--	--	--	●	--	●	--	--	--	--	--	●	--	--	●	
		17 - 25	Styleside	6' 9"	--	--	--	●	--	--	●	--	--	--	●	--	●	--	--	--	--	--	--	●	--	--	●
		11 - 16	Styleside	6' 9"	--	--	--	--	--	--	--	--	●	--	--	--	--	--	--	--	--	--	--	●	--	--	--
		11 - 16	Styleside	8'	--	--	--	●	--	--	●	--	--	--	●	--	●	--	--	--	--	--	--	●	--	--	●
		99 - 10	Styleside	6' 9"	--	--	--	●	--	--	●	--	--	--	●	--	●	--	--	--	--	--	--	●	--	--	●
		99 - 10	Styleside	8'	--	--	--	●	--	--	●	--	--	--	●	--	●	--	--	--	--	--	--	●	--	--	●
	Extended	17 - 25	Styleside	6' 9"	--	--	--	●	--	--	●	--	--	--	●	--	●	--	--	--	--	--	--	●	--	--	●
		17 - 25	Styleside	8'	--	--	--	●	--	--	●	--	--	--	●	--	●	--	--	--	--	--	--	●	--	--	●
		11 - 16	Styleside	6' 9"	--	--	--	--	--	--	--	--	●	--	--	--	--	--	--	--	--	--	--	●	--	--	--
		11 - 16	Styleside	8'	--	--	--	●	--	--	●	--	--	--	●	--	●	--	--	--	--	--	--	●	--	--	●
	Standard	99 - 10	Styleside	6' 9"	--	--	--	●	--	--	●	--	--	--	●	--	●	--	--	--	--	--	--	●	--	--	●
		99 - 10	Styleside	8'	--	--	--	●	--	--	●	--	--	--	●	--	●	--	--	--	--	--	--	●	--	--	●
		17 - 25	Styleside	8'	--	--	--	●	--	--	●	--	--	--	●	--	●	--	--	--	--	--	--	●	--	--	●
		11 - 16	Styleside	6' 9"	--	--	--	--	--	--	--	--	●	--	--	--	--	--	--	--	--	--	--	●	--	--	--
F-450 Super Duty	Crew	17 - 25	Styleside	8'	--	--	--	●	--	●	--	--	--	●	--	●	--	--	--	--	--	--	●	--	--	●	
	Standard	19 - 25	Styleside	8'	--	--	--	●	--	●	--	--	--	●	--	●	--	--	--	--	--	--	●	--	--	●	
Maverick	Crew	22 - 24	Styleside	4' 6"	--	--	--	--	--	--	--	--	--	--	--	--	--	--	--	--	--	--	--	--	--	--	
Ranger	Crew	24 - 25	Fleetside	5'	--	--	--	--	--	--	--	--	●	--	--	--	--	--	--	●	●	--	--	--	--	--	
		19 - 23	Styleside	5'	--	●	--	--	--	--	--	--	--	--	--	--	--	--	--	●	●	--	--	--	--	--	
	Extended	19 - 23	Styleside	6'	--	●	--	--	--	--	--	--	--	--	--	--	--	--	--	●	●	--	--	--	--	--	
		06 - 11	Styleside	6'	--	●	--	--	--	--	--	--	●	--	--	--	--	--	--	●	●	--	--	--	--	--	
Standard	98 - 11	Styleside	6'	--	●	--	--	--	--	--	--	●	--	--	--	--	--	--	●	●	--	--	--	--	--		
	98 - 11	Styleside	7'	--	●	--	--	--	--	--	--	●	--	--	--	--	--	--	●	●	--	--	--	--	--		
GMC																											
Canyon	Crew	23 - 25	Fleetside	5'	--	--	--	--	--	--	--	●	--	--	--	--	--	--	●	--	--	--	--	--	--	--	
		19 - 22	Fleetside	5'	--	●	--	--	--	--	--	--	●	--	--	--	--	--	--	●	●	--	--	--	--	--	
		15 - 18	Fleetside	5' 6"	--	●	--	--	--	--	--	--	●	--	--	--	--	--	--	●	●	--	--	--	--	--	
		15 - 18	Fleetside	6'	--	●	--	--	--	--	--	--	●	--	--	--	--	--	--	●	●	--	--	--	--	--	
		04 - 12	Fleetside	5' 5"	--	--	--	--	--	--	--	--	--	--	--	--	--	--	--	--	--	--	--	--	--	--	
	Extended	15 - 18	Fleetside	6'	--	--	--	--	--	--	--	--	●	--	--	--	--	--	--	●	●	--	--	--	--	--	
		04 - 12	Fleetside	6'	--	--	--	--	--	--	--	--	--	--	--	--	--	--	--	--	--	--	--	--	--	--	
	Standard	04 - 12	Fleetside	6'	--	--	--	--	--	--	--	--	--	--	--	--	--	--	--	--	--	--	--	--	--	--	
Sierra 1500 (continued on the following page)	Crew	14 - 25	Fleetside	5' 8"	--	--	●	--	●	--	--	●	--	●	--	●	--	--	--	●	●	--	●	●	--	●	
		14 - 25	Fleetside	6' 6"	--	--	●	--	●	●	--	--	●	--	●	--	●	--	--	--	●	●	--	●	●	--	
		07 - 13	Fleetside	5' 8"	--	--	●	--	--	--	--	--	●	--	●	--	●	--	--	--	●	●	--	●	●	--	
		04 - 06	Fleetside	8'	--	--	●	--	●	●	--	--	●	--	●	--	●	--	--	--	●	●	--	●	●	--	
		99 - 06	Fleetside	5' 8.5"	--	--	●	--	--	--	--	--	●	--	●	--	●	--	--	--	●	●	--	●	●	--	
	Extended	14 - 25	Fleetside	6' 6"	--	--	●	--	●	●	--	--	●	--	●	--	●	--	--	--	●	●	--	●	●	--	
		07 - 13	Fleetside	6' 6"	--	--	●	--	●	●	--	--	●	--	●	--	●	--	--	--	●	●	--	●	●	--	
		07 - 13	Fleetside	8'	--	--	●	--	●	●	--	--	●	--	●	--	●	--	--	--	●	●	--	●	●	--	
		99 - 05	Stepside	6' 6"	--	--	--	--	--	--	--	--	--	--	--	--	--	--	--	--	--	--	--	--	--	--	
Standard	99 - 06	Fleetside	6' 6"	--	--	●	--	●	●	--	--	●	--	●	--	●	--	--	--	●	●	--	●	●	--		
	99 - 06	Fleetside	8'	--	--	●	--	●	●	--	--	●	--	●	--	●	--	--	--	●	●	--	●	●	--		

Footnotes	For the most up-to-date application information please visit uwsta.com	
1 If your model is equipped with a factory, hard-plastic tonneau system covering the bed rail, a crossover tool box will not fit.	3 If your model is equipped with a factory track-system, standard box-mounting may not apply.	* For Gloss Black, add -B instead of -BLK
2 If your model is equipped with a Ram Box, a crossover tool box will not fit.	4 If your model is equipped with a factory bed-rail system, standard box-mounting may not apply.	† For Matte Black with rail, use part# SLD69-A-LP-MB-R



Available ordering options
(listed above part numbers)

All part #s listed are Bright Aluminum. Use key below to identify alternative finishes or to add a rail. Then add desired suffix shown to end of part #.

A - Matte Black (add **-MB**)
B - Aluminum with Rail (add **-R**)
C - Matte Black with Rail (add **-MB-R**)
D - Gloss Black (add **-BLK**)
E - Gloss Black with Rail (add **-BLK-R**)

Standard	D	Std	Gull Wing				Slim Line			
			Standard		Deep		Standard		Deep	
			A	A,B,C,D,E	A,B,C,D,E	A,C,T,D	A,D*	A,D*	D	D

Make / Model	Cab Length	Years	Bed Style	Bed Leng.	Foot Note	SL-63-A-LP	SL-69-LP	SL-72-LP	SLD-69-A-LP	TBS-69-LP-PH	TBS-72-LP-PH	TB-60	TB-63	TB-69	TB-72	TBD-69	TBD-72	TBS-60-SL	TBS-63-SL	TBS-63-SL-LP	TBS-69-SL	TBS-69-SL-LP	TBS-72-SL	TBSD-69-SL	TBSD-69-SL-LP	TBSD-72-SL-LP			
GMC (continued)																													
Sierra 1500 (continued from the previous page)	Standard	14 - 25	Fleetside	6' 6"	--	--	●	--	●	●	--	--	--	●	--	●	--	--	--	--	●	●	--	●	●	--	●	●	
		14 - 25	Fleetside	8'	--	--	●	--	●	●	--	--	--	●	--	●	--	--	--	--	--	●	●	--	●	●	--	●	●
		07 - 13	Fleetside	6' 6"	--	--	●	--	●	●	--	--	--	●	--	●	--	--	--	--	--	●	●	--	●	●	--	●	●
		07 - 13	Fleetside	8'	--	--	●	--	●	●	--	--	--	●	--	●	--	--	--	--	--	●	●	--	●	●	--	●	●
		99 - 05	Stepside	6' 6"	--	--	--	--	--	--	--	--	--	--	--	--	--	--	--	--	--	--	--	--	--	--	--	--	--
		99 - 06	Fleetside	6' 6"	--	--	●	--	●	●	--	--	--	●	--	●	--	●	--	--	--	--	●	●	--	●	●	--	●
Sierra 1500 Classic	Crew	07 - 07	Fleetside	5' 8.5"	--	--	--	--	--	--	--	--	--	●	--	●	--	--	--	--	●	●	--	●	●	--	●	●	
		07 - 07	Fleetside	8'	--	--	●	--	●	●	--	--	--	●	--	●	--	--	--	--	--	●	●	--	●	●	--	●	●
	Extended	07 - 07	Fleetside	6' 6"	--	--	●	--	●	●	--	--	--	●	--	●	--	--	--	--	--	●	●	--	●	●	--	●	●
		07 - 07	Fleetside	8'	--	--	●	--	●	●	--	--	--	●	--	●	--	--	--	--	--	●	●	--	●	●	--	●	●
Sierra 1500 Limited	Crew	22 - 22	Fleetside	5' 8"	--	--	●	--	●	●	--	--	--	●	--	●	--	--	--	--	●	●	--	●	●	--	●	●	
		22 - 22	Fleetside	6' 6"	--	--	●	--	●	●	--	--	--	●	--	●	--	--	--	--	--	●	●	--	●	●	--	●	●
	Extended	22 - 22	Fleetside	6' 6"	--	--	●	--	●	●	--	--	--	●	--	●	--	--	--	--	--	●	●	--	●	●	--	●	●
		19 - 19	Fleetside	6' 6"	--	--	●	--	●	●	--	--	--	●	--	●	--	--	--	--	--	●	●	--	●	●	--	●	●
Sierra 2500	Crew	04 - 04	Fleetside	8'	--	--	●	--	●	●	--	--	--	●	--	●	--	--	--	--	●	●	--	●	●	--	●	●	
		99 - 04	Fleetside	6' 6"	--	--	●	--	●	●	--	--	--	●	--	●	--	--	--	--	--	●	●	--	●	●	--	●	●
	Extended	99 - 04	Fleetside	8'	--	--	●	--	●	●	--	--	--	●	--	●	--	--	--	--	--	●	●	--	●	●	--	●	●
		99 - 04	Fleetside	6' 6"	--	--	●	--	●	●	--	--	--	●	--	●	--	--	--	--	--	●	●	--	●	●	--	●	●
Sierra 2500 HD	Crew	20 - 25	Fleetside	7'	--	--	●	--	●	●	--	--	--	●	--	●	--	--	--	--	●	●	--	●	●	--	●	●	
		20 - 25	Fleetside	8'	--	--	●	--	●	●	--	--	--	●	--	●	--	--	--	--	--	●	●	--	●	●	--	●	●
		15 - 19	Fleetside	6' 6"	--	--	●	--	●	●	--	--	--	●	--	●	--	--	--	--	--	●	●	--	●	●	--	●	●
		15 - 19	Fleetside	8'	--	--	●	--	●	●	--	--	--	●	--	●	--	--	--	--	--	●	●	--	●	●	--	●	●
	Extended	01 - 06	Fleetside	8'	--	--	●	--	●	●	--	--	--	●	--	●	--	--	--	--	--	●	●	--	●	●	--	●	●
		01 - 19	Fleetside	6' 6"	--	--	●	--	●	●	--	--	--	●	--	●	--	--	--	--	--	●	●	--	●	●	--	●	●
		20 - 25	Fleetside	7'	--	--	●	--	●	●	--	--	--	●	--	●	--	--	--	--	--	●	●	--	●	●	--	●	●
		01 - 25	Fleetside	8'	--	--	●	--	●	●	--	--	--	●	--	●	--	--	--	--	--	●	●	--	●	●	--	●	●
Standard	01 - 06	Fleetside	6' 6"	--	--	●	--	●	●	--	--	--	●	--	●	--	--	--	--	--	●	●	--	●	●	--	●	●	
	01 - 25	Fleetside	8'	--	--	●	--	●	●	--	--	--	●	--	●	--	--	--	--	--	●	●	--	●	●	--	●	●	
Sierra 2500 HD Classic	Crew	07 - 07	Fleetside	8'	--	--	●	--	●	●	--	--	--	●	--	●	--	--	--	--	●	●	--	●	●	--	●	●	
		07 - 07	Fleetside	6' 6"	--	--	●	--	●	●	--	--	--	●	--	●	--	--	--	--	--	●	●	--	●	●	--	●	●
	Extended	07 - 07	Fleetside	8'	--	--	●	--	●	●	--	--	--	●	--	●	--	--	--	--	--	●	●	--	●	●	--	●	●
		07 - 07	Fleetside	6' 6"	--	--	●	--	●	●	--	--	--	●	--	●	--	--	--	--	--	●	●	--	●	●	--	●	●
Standard	07 - 07	Fleetside	6' 6"	--	--	●	--	●	●	--	--	--	●	--	●	--	--	--	--	--	●	●	--	●	●	--	●	●	
	07 - 07	Fleetside	8'	--	--	●	--	●	●	--	--	--	●	--	●	--	--	--	--	--	●	●	--	●	●	--	●	●	
Sierra 3500	Crew	01 - 06	Fleetside	8'	--	--	●	--	●	●	--	--	--	●	--	●	--	--	--	--	●	●	--	●	●	--	●	●	
	Extended	01 - 06	Fleetside	8'	--	--	●	--	●	●	--	--	--	●	--	●	--	--	--	--	--	●	●	--	●	●	--	●	●
	Standard	01 - 06	Fleetside	8'	--	--	●	--	●	●	--	--	--	●	--	●	--	--	--	--	--	●	●	--	●	●	--	●	●
Sierra 3500 Classic	Crew	07 - 07	Fleetside	8'	--	--	●	--	●	●	--	--	--	●	--	●	--	--	--	--	●	●	--	●	●	--	●	●	
	Extended	07 - 07	Fleetside	8'	--	--	●	--	●	●	--	--	--	●	--	●	--	--	--	--	--	●	●	--	●	●	--	●	●
	Standard	07 - 07	Fleetside	8'	--	--	●	--	●	●	--	--	--	●	--	●	--	--	--	--	--	●	●	--	●	●	--	●	●

Footnotes	For the most up-to-date application information please visit uwsta.com	
1 If your model is equipped with a factory, hard-plastic tonneau system covering the bed rail, a crossover tool box will not fit.	3 If your model is equipped with a factory track-system, standard box-mounting may not apply.	* For Gloss Black, add -B instead of -BLK
2 If your model is equipped with a Ram Box, a crossover tool box will not fit.	4 If your model is equipped with a factory bed-rail system, standard box-mounting may not apply.	† For Matte Black with rail, use part# SLD69-A-LP-MB-R



Available ordering options
(listed above part numbers)

All part #s listed are Bright Aluminum. Use key below to identify alternative finishes or to add a rail. Then add desired suffix shown to end of part #.

A - Matte Black (add **-MB**)
B - Aluminum with Rail (add **-R**)
C - Matte Black with Rail (add **-MB-R**)
D - Gloss Black (add **-BLK**)
E - Gloss Black with Rail (add **-BLK-R**)

Make / Model	Cab Length	Years	Bed Style	Bed Leng.	Foot Note	Secure Lock			Pull Hdle		Gull Wing				Slim Line											
						Standard		D	Std	Standard		Deep		Standard		Deep										
						A	A,B,C,D,E	A,B,C,D,E	A,C,T,D	A,D*	A,D*	--	--	--	--	--	--	D	D	D	D	D	D	D	D	D
SL-63-A-LP	SL-69-LP	SL-72-LP	SLD-69-A-LP	TBS-69-LP-PH	TBS-72-LP-PH	TB-60	TB-63	TB-69	TB-72	TBD-69	TBD-72	TBS-60-SL	TBS-63-SL	TBS-63-SL-LP	TBS-69-SL	TBS-69-SL-LP	TBS-72-SL	TBSD-69-SL	TBSD-69-SL-LP	TBSD-72-SL-LP						
GMC (continued)																										
Sierra 3500 HD	Crew	20 - 25	Fleetside	7'	--	--	●	--	●	●	--	--	--	●	--	●	--	--	--	--	●	●	--	●	●	--
		20 - 25	Fleetside	8'	--	--	●	--	●	●	--	--	--	●	--	●	--	--	--	--	●	●	--	●	●	--
		15 - 19	Fleetside	6' 6"	--	--	●	--	●	●	--	--	--	●	--	●	--	--	--	--	●	●	--	●	●	--
		15 - 19	Fleetside	8'	--	--	●	--	●	●	--	--	--	●	--	●	--	--	--	--	●	●	--	●	●	--
	Extended	11 - 19	Fleetside	6' 6"	--	--	●	--	●	●	--	--	--	●	--	●	--	--	--	--	●	●	--	●	●	--
		07 - 25	Fleetside	8'	--	--	●	--	●	●	--	--	--	●	--	●	--	--	--	--	●	●	--	●	●	--
Standard	07 - 25	Fleetside	8'	--	--	●	--	●	●	--	--	--	●	--	●	--	--	--	--	●	●	--	●	●	--	
Sonoma	Crew	01 - 04	Fleetside	4' 8"	--	--	--	--	--	--	●	--	--	--	--	--	--	--	--	--	--	--	--	--	--	
	Extended	94 - 04	Fleetside	6'	--	--	--	--	--	--	●	--	--	--	--	--	--	--	--	--	--	--	--	--	--	
	Standard	96 - 04	Stepside	6'	--	--	--	--	--	--	--	--	--	--	--	--	--	--	--	--	--	--	--	--	--	
		94 - 04	Fleetside	6'	--	--	--	--	--	--	●	--	--	--	--	--	--	--	--	--	--	--	--	--	--	
94 - 04	Fleetside	7' 6"	--	--	--	--	--	--	--	●	--	--	--	--	--	--	--	--	--	--	--	--	--	--		
Honda																										
Ridgeline	Crew	06 - 14	Fleetside	5'	--	--	--	--	--	--	●	--	--	--	--	--	--	--	--	--	--	--	--	--	--	
Hummer																										
H3T	Crew	09 - 10	Styleside	5' 5"	3	--	--	--	--	--	●	--	--	--	--	--	--	--	--	--	--	--	--	--	--	
Jeep																										
Gladiator	Crew	20 - 25	Styleside	5'	--	--	--	--	--	--	--	--	--	--	--	--	--	--	--	--	--	--	--	--	--	
Lincoln																										
Mark LT	Crew	06 - 08	Styleside	5' 6"	--	--	--	--	--	--	--	--	●	--	--	--	--	--	--	--	●	●	--	--	--	
Mazda																										
B2300	Extended	03 - 04	Styleside	6'	--	●	--	--	--	--	●	--	--	--	●	●	--	--	--	--	--	--	--	--	--	
	Standard	01 - 10	Styleside	6'	--	●	--	--	--	--	●	--	--	--	●	●	--	--	--	--	--	--	--	--	--	
B2500	Extended	98 - 00	Styleside	6'	--	●	--	--	--	--	●	--	--	--	●	●	--	--	--	--	--	--	--	--	--	
	Standard	98 - 01	Styleside	6'	--	●	--	--	--	--	●	--	--	--	●	●	--	--	--	--	--	--	--	--	--	
B3000	Extended	99 - 08	Styleside	6'	--	●	--	--	--	--	●	--	--	--	●	●	--	--	--	--	--	--	--	--	--	
	Standard	98 - 07	Styleside	6'	--	●	--	--	--	--	●	--	--	--	●	●	--	--	--	--	--	--	--	--	--	
B4000	Extended	00 - 10	Styleside	6'	--	●	--	--	--	--	●	--	--	--	●	●	--	--	--	--	--	--	--	--	--	
Mitsubishi																										
Raider	Extended	06 - 09	Styleside	5' 6"	--	--	--	--	--	--	--	--	--	--	●	●	--	--	--	--	--	--	--	--	--	
Nissan																										
Frontier	Crew	05 - 21	Styleside	5'	--	●	--	--	--	--	●	--	--	--	●	●	--	--	--	--	--	--	--	--	--	
		22 - 24	Styleside	6'	--	--	--	--	--	--	--	●	--	--	--	●	●	--	--	--	--	--	--	--	--	
		05 - 21	Styleside	6'	--	●	--	--	--	--	●	--	--	--	●	●	--	--	--	--	--	--	--	--	--	
		00 - 04	Styleside	5'	--	--	--	--	--	--	--	--	--	--	--	●	●	--	--	--	--	--	--	--	--	
	Extended	00 - 04	Styleside	6' 6"	--	--	--	--	--	--	--	--	--	--	●	●	--	--	--	--	--	--	--	--	--	
		05 - 21	Styleside	6'	--	●	--	--	--	--	●	--	--	--	●	●	--	--	--	--	--	--	--	--	--	
Standard	98 - 04	Styleside	6' 6"	--	--	--	--	--	--	--	--	--	--	●	●	--	--	--	--	--	--	--	--	--		
Titan	Crew	98 - 01	Styleside	6' 6"	--	--	--	--	--	--	--	--	--	--	●	●	--	--	--	--	--	--	--	--		
		17 - 24	Styleside	6' 6"	--	--	--	--	--	--	--	--	--	--	--	--	--	--	--	--	--	--	--	--		
	Extended	04 - 15	Styleside	5' 6"	--	--	●	--	●	●	--	--	●	--	●	●	--	--	--	--	●	●	--	●	●	
		04 - 15	Styleside	6' 6"	--	--	●	--	●	●	--	--	●	--	●	●	--	--	--	--	●	●	--	●	●	
08 - 14	Styleside	7'	--	--	●	--	●	●	--	--	●	--	●	●	--	--	--	--	●	●	--	●	●			
08 - 09	Styleside	8'	--	--	●	--	●	●	--	--	●	--	●	●	--	--	--	--	●	●	--	●	●			
Titan XD	Crew	16 - 23	Styleside	6' 6"	--	--	--	--	--	--	--	--	--	--	--	--	--	--	--	--	--	--	--	--		

Footnotes	For the most up-to-date application information please visit uwsta.com	
1 If your model is equipped with a factory, hard-plastic tonneau system covering the bed rail, a crossover tool box will not fit.	3 If your model is equipped with a factory track-system, standard box-mounting may not apply.	* For Gloss Black, add -B instead of -BLK
2 If your model is equipped with a Ram Box, a crossover tool box will not fit.	4 If your model is equipped with a factory bed-rail system, standard box-mounting may not apply.	† For Matte Black with rail, use part# SLD69-A-LP-MB-R



Available ordering options
(listed above part numbers)

All part #s listed are Bright Aluminum. Use key below to identify alternative finishes or to add a rail. Then add desired suffix shown to end of part #.

A - Matte Black (add **-MB**)
B - Aluminum with Rail (add **-R**)
C - Matte Black with Rail (add **-MB-R**)
D - Gloss Black (add **-BLK**)
E - Gloss Black with Rail (add **-BLK-R**)

Make / Model	Cab Length	Years	Bed Style	Bed Leng.	Foot Note	Secure Lock			Pull Hdle		Gull Wing				Slim Line							
						Standard		D	Std	Standard		Deep		Standard		Deep						
						A	A,B,C,D,E	A,B,C,D,E	A,C,T,D	A,D*	A,D*	--	--	--	--	--	--	D	D	D	D	D
SL-63-A-LP	SL-69-LP	SL-72-LP	SLD-69-A-LP	TBS-69-LP-PH	TBS-72-LP-PH	TB-60	TB-63	TB-69	TB-72	TBD-69	TBD-72	TBS-60-SL	TBS-63-SL	TBS-63-SL-LP	TBS-69-SL	TBS-69-SL-LP	TBS-72-SL	TBSD-69-SL	TBSD-69-SL-LP	TBSD-72-SL-LP		
Ram																						
1500	Crew	19 - 25	Fleetside	5' 7"	2	--	●	--	●	●	--	--	--	●	--	--	--	--	--	●	●	--
		19 - 25	Fleetside	6' 4"	2	--	●	--	●	●	--	--	--	●	--	--	--	--	--	●	●	--
	Extended	19 - 25	Fleetside	5' 7"	2	--	●	--	●	●	--	--	--	●	--	--	--	--	--	●	●	--
		11 - 18	Fleetside	5' 7"	2	--	--	●	--	●	●	--	--	●	--	--	--	--	--	●	●	--
	Standard	11 - 18	Fleetside	6' 4"	2	--	--	●	--	●	●	--	--	●	--	--	--	--	--	●	●	--
		11 - 18	Fleetside	6' 4"	2	--	--	●	--	●	●	--	--	●	--	--	--	--	--	●	●	--
1500 Classic	Extended	19 - 24	Fleetside	5' 7"	2	--	--	●	--	●	--	--	●	--	--	--	--	--	●	●	--	
		19 - 24	Fleetside	6' 4"	2	--	--	●	--	●	●	--	--	●	--	--	--	--	●	●	--	
	Standard	19 - 24	Fleetside	6' 4"	2	--	--	●	--	●	●	--	--	●	--	--	--	--	●	●	--	
2500	Crew	11 - 25	Fleetside	6' 4"	2	--	--	●	--	●	--	--	●	--	--	--	--	--	●	●	--	
		11 - 25	Fleetside	8'	--	--	--	●	--	●	●	--	--	●	--	--	--	--	●	●	--	
	Extended Crew	11 - 25	Fleetside	6' 4"	2	--	--	●	--	●	●	--	--	●	--	--	--	--	●	●	--	
		11 - 25	Fleetside	8'	--	--	--	●	--	●	●	--	--	●	--	--	--	--	●	●	--	
	Standard	11 - 25	Fleetside	6' 4"	2	--	--	●	--	●	●	--	--	●	--	--	--	--	●	●	--	
3500	Crew	11 - 25	Fleetside	6' 4"	2	--	--	●	--	●	--	--	●	--	--	--	--	--	●	●	--	
		11 - 25	Fleetside	8'	--	--	--	●	--	●	●	--	--	●	--	--	--	--	●	●	--	
	Extended Crew	11 - 25	Fleetside	6' 4"	2	--	--	●	--	●	●	--	--	●	--	--	--	--	●	●	--	
		11 - 25	Fleetside	8'	--	--	--	●	--	●	●	--	--	●	--	--	--	--	●	●	--	
	Standard	11 - 25	Fleetside	6' 4"	2	--	--	●	--	●	●	--	--	●	--	--	--	--	●	●	--	
Dakota	Extended	11 - 11	Fleetside	5' 6"	--	--	--	--	--	--	--	--	--	--	--	--	--	--	--	--		
Suzuki																						
Equator	Crew	09 - 12	Styleside	5'	--	●	--	--	--	--	--	--	●	--	--	--	--	--	●	●	--	
		09 - 12	Styleside	6'	--	●	--	--	--	--	--	--	--	●	--	--	--	--	--	●	●	--
Toyota																						
Tacoma	Crew	19 - 25	Fleetside	5'	4	●	--	--	--	--	--	--	●	--	--	--	--	--	●	●	--	
		05 - 15	Fleetside	5'	4	--	--	--	--	--	--	--	--	--	--	--	--	--	--	●	●	--
		05 - 15	Fleetside	6'	4	--	--	--	--	--	--	--	--	--	--	--	--	--	--	●	●	--
	Extended	19 - 23	Fleetside	6'	4	●	--	--	--	--	--	--	--	●	--	--	--	--	--	●	●	--
		05 - 15	Fleetside	6'	4	--	--	--	--	--	--	--	--	--	--	--	--	--	--	●	●	--
	Standard	05 - 14	Fleetside	6'	4	--	--	--	--	--	--	--	--	--	--	--	--	--	--	●	●	--
Tundra	Crew	07 - 21	Fleetside	5' 5"	--	--	●	--	--	●	--	--	--	●	--	--	--	--	●	●	--	
		07 - 21	Fleetside	6' 6"	--	--	●	--	--	●	--	--	--	●	--	--	--	--	●	●	--	
	Extended	07 - 21	Fleetside	8'	--	--	●	--	●	--	--	--	--	●	--	--	--	--	●	●	--	
		00 - 06	Fleetside	6' 5"	--	--	--	--	--	--	--	--	--	--	--	--	--	--	--	--	--	
		07 - 17	Fleetside	6' 6"	--	--	●	--	--	●	--	--	--	--	--	--	--	--	●	●	--	
		07 - 17	Fleetside	8'	--	--	●	--	●	--	--	--	--	●	--	--	--	--	●	●	--	
		00 - 04	Fleetside	6' 5"	--	--	--	--	--	--	--	--	--	--	--	--	--	--	--	--	--	
Standard	00 - 06	Fleetside	8'	--	--	--	--	--	--	--	--	--	--	--	--	--	--	--	--			

Footnotes	For the most up-to-date application information please visit uwsta.com	
1 If your model is equipped with a factory, hard-plastic tonneau system covering the bed rail, a crossover tool box will not fit.	3 If your model is equipped with a factory track-system, standard box-mounting may not apply.	* For Gloss Black, add -B instead of -BLK
2 If your model is equipped with a Ram Box, a crossover tool box will not fit.	4 If your model is equipped with a factory bed-rail system, standard box-mounting may not apply.	† For Matte Black with rail, use part# SLD69-A-LP-MB-R



UTILITY CHEST BOXES

FEATURED PRODUCTS



Under tonneau boxes

These utility chests are built with a 16-1/2" height and an offset lid to be compatible with most truck bed tonneau covers.



5th wheel boxes

These boxes accommodate a 5th wheel hitch mounted in the truck bed to provide optimal clearance with a 5th wheel trailer in tow.

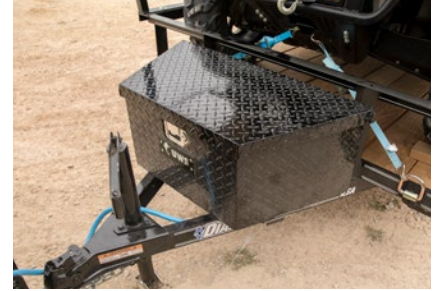

Trailer tongue boxes

Perfect for equipment and trailer accessories, these boxes mount onto the trailer tongue on both straight-tongue and A-frame trailers.

PRODUCT INDEX



40
Under Tonneau
Chest Boxes



42
Notched
Chest Boxes



44
Wedged
Chest Boxes



46
5th Wheel
Chest Boxes



48
Standard
Chest Boxes



50
Trailer Tongue
Chest Boxes



52
Tote
Boxes



52
Foot
Lockers

SECURE LOCK UNDER TONNEAU CHEST BOXES



Product Details

- 16-1/2" high with offset lid to be compatible with most tonneau covers
- Patented RigidCore™ foam-filled lid maximizes strength and prevents binding
- 0.058" extra-thick, one-piece aluminum tub holds heavy tools and cargo
- Easy-to-operate, dual-locking twist handles for enhanced security
- Connecting rod allows for convenient operation from driver or passenger side
- Interior rod enclosure helps prevent bending and jamming of lock system
- MicroSeal™ gasket helps seal out moisture, dust, and dirt
- Strut-actuated lid opens 90° for convenient operation and loading (may be limited by tonneau cover style)
- Mounting hardware sold separately



SLC-48

SLC-48-MB

Finishes & Material



Finish:
Bright aluminum
Material:
0.058" aluminum



Finish:
Matte black
Material:
0.058" aluminum

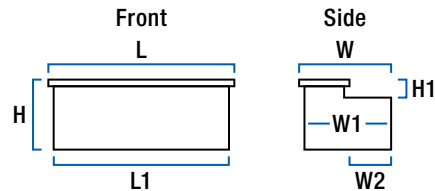

Part #	Finish	Cubic Feet	Dimensions (inches)						
			L	L1	W	W1	W2	H	H1
SLC-48	Bright aluminum	8.85	48	47	24.5	24	9.75	16.5	3.75
SLC-48-MB	Matte black	8.85	48	47	24.5	24	9.75	16.5	3.75

Utility Chest Mounting Kit

- Compatible with UWS utility chest boxes

Part #	Includes
003-CBOXMK	Two flange bolts, flat washers, and turn nuts

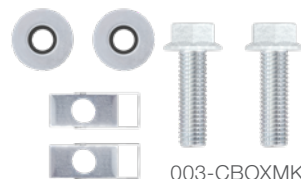

003-CBOXMK



NOTCHED CHEST BOXES



Product Details

- Designed to optimize capacity while avoiding wheel wells and bed accessories
- Offers highly secure storage for tools, equipment, or personal items
- 0.058" extra-thick, one-piece aluminum tub holds heavy tools and cargo
- Stainless steel lock handles for security and corrosion-resistant operation
- Connecting rod allows for convenient operation from driver or passenger side
- Interior rod enclosure helps prevent bending or jamming of lock system
- MicroSeal™ gasket helps seal out moisture, dust, and dirt
- Strut-actuated lid opens 90° for convenient operation and loading
- Mounting hardware sold separately



Finishes & Material



Finish:
Bright
aluminum

Material:
0.058"
aluminum



Finish:
Gloss
black

Material:
0.058"
aluminum

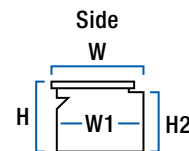
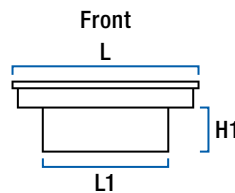

Part #	Finish	Cubic Feet	Dimensions (inches)						
			L	L1	W	W1	H	H1	H2
TBC-60-N	Bright aluminum	10.3	60	48	20	19.5	18.75	9.75	14.75
TBC-60-N-BLK	Gloss black	10.3	60	48	20	19.5	18.75	9.75	14.75

Utility Chest Mounting Kit

- Compatible with UWS utility chest boxes

Part #	Includes
003-CBOXMK	Two flange bolts, flat washers, and turn nuts

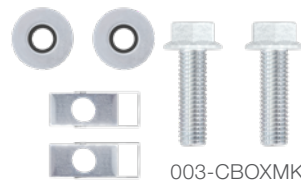



WEDGED CHEST BOXES



Product Details

- Wedge design optimizes capacity while avoiding wheel wells and bed accessories
- Patented RigidCore™ foam-filled lid maximizes strength and prevents binding
- 0.058" extra-thick, one-piece aluminum tub holds heavy tools and cargo
- Stainless steel lock handles for security and corrosion-resistant operation
- Connecting rod allows for convenient operation from driver or passenger side
- Interior rod enclosure helps prevent bending or jamming of lock system
- MicroSeal™ gasket helps seal out moisture, dust, and dirt
- Strut actuated lid opens 90° for convenient operation and loading
- Mounting hardware available, see page 42



Finishes & Material



Finish:
Bright
aluminum

Material:
0.058"
aluminum



Finish:
Gloss
black

Material:
0.058"
aluminum

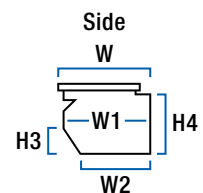
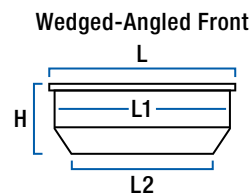
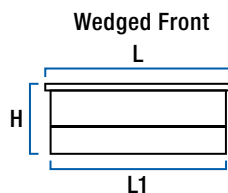

Part #	Finish	Angled	Cubic Feet	Dimensions (inches)								
				L	L1	L2	W	W1	W2	H	H3	H4
TBC-36-W	Bright alum.	No	7.2	37	36	--	20.5	20	17.75	18.5	7.5	14.5
TBC-36-W-BLK	Gloss black	No	7.2	37	36	--	20.5	20	17.75	18.5	7.5	14.5
TBC-42-W	Bright alum.	No	8.4	43	42	--	20.5	20	17.75	18.5	7.5	14.5
TBC-42-W-BLK	Gloss black	No	8.4	43	42	--	20.5	20	17.75	18.5	7.5	14.5
TBC-48-W	Bright alum.	No	9.6	49	48	--	20.5	20	17.75	18.5	7.5	14.5
TBC-48-W-BLK	Gloss black	No	9.6	49	48	--	20.5	20	17.75	18.5	7.5	14.5
TBC-55-W	Bright alum.	No	11	55	54	--	20.5	20	17.75	18.5	7.5	14.5
TBC-55-W-BLK	Gloss black	No	11	55	54	--	20.5	20	17.75	18.5	7.5	14.5
TBC-55-WN	Bright alum.	Yes	10.4	56	55	41	22	21.5	17.5	21	10.5	15.25
TBC-55-WN-BLK	Gloss black	Yes	10.4	56	55	41	22	21.5	17.5	21	10.5	15.25
TBC-60-W	Bright alum.	No	12	61	60	--	24.75	24	17.75	21.25	7.5	14.5
TBC-60-W-BLK	Gloss black	No	12	61	60	--	24.75	24	17.75	21.25	7.5	14.5
TBC-62-WN	Bright alum.	Yes	10.8	63	62	54	21.5	21	15.75	18.5	8.75	13
TBC-62-WN-BLK	Gloss black	Yes	10.8	63	62	54	21.5	21	15.75	18.5	8.75	13



5TH WHEEL CHEST BOXES



Product Details

- Low-profile design provides plenty of clearance when towing a 5th wheel trailer
- Patented RigidCore™ foam-filled lid maximizes strength and prevents binding
- Designed to mount inside the truck bed, leaving bed rails free for other use
- 0.058" extra-thick, one-piece aluminum tub holds heavy tools and cargo
- Stainless steel lock handles for security and corrosion-resistant operation
- Connecting rod allows for convenient operation from driver or passenger side
- Interior rod enclosure helps prevent bending or jamming of lock system
- MicroSeal™ gasket helps seal out moisture, dust, and dirt
- Strut-actuated lid opens 90° for convenient operation and loading
- Mounting hardware sold separately



FWB-58-BLK



FW-58



FWB-58-MB

Finishes & Material



Finish:
Bright
aluminum

Material:
0.058"
aluminum



Finish:
Gloss
black

Material:
0.058"
aluminum

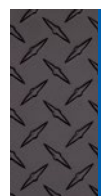

Finish:
Matte
black

Material:
0.058"
aluminum

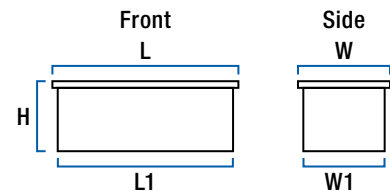

Part #	Finish	Cubic Feet	Dimensions (inches)				
			L	L1	W	W1	H
FWB-58	Bright aluminum	6.1	59	58	18.75	18	11.25
FWB-58-MB	Matte black	6.1	59	58	18.75	18	11.25
FWB-58-BLK	Gloss black	6.1	59	58	18.75	18	11.25

Utility Chest Mounting Kit

- Compatible with UWS utility chest boxes

Part #	Includes
003-CBOXMK	Two flange bolts, flat washers, and turn nuts

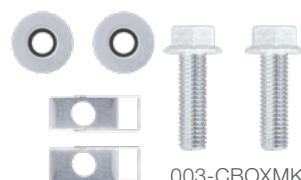

003-CBOXMK



Scan QR code for instructions on measuring a truck bed for a tool box or transfer tank



STANDARD CHEST BOXES



Product Details

- Offers highly secure storage for tools, equipment, or personal items
- Patented RigidCore™ foam-filled lid maximizes strength and prevents binding
- 0.058" extra-thick, one-piece aluminum tub holds heavy tools and cargo
- Stainless steel lock handles for security and corrosion-resistant operation
- MicroSeal™ gasket helps seal out moisture, dust, and dirt
- Strut-actuated lid opens 90° for convenient operation and loading
- Mounting hardware sold separately



Finishes & Material



Finish:
Bright
aluminum

Material:
0.058"
aluminum



Finish:
Gloss
black

Material:
0.058"
aluminum

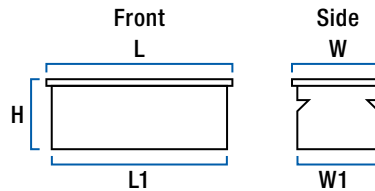

Part #	Finish	Cubic Feet	Dimensions (inches)				
			L	L1	W	W1	H
TBC-30	Bright aluminum	5.3	31	30	20	19.25	17.25
TBC-30-BLK	Gloss black	5.3	31	30	20	19.25	17.25
TBC-36	Bright aluminum	7.2	37	36	20	19.25	19
TBC-36-BLK	Gloss black	7.2	37	36	20	19.25	19
TBC-42	Bright aluminum	8.4	43	42	20	19.25	19
TBC-42-BLK	Gloss black	8.4	43	42	20	19.25	19
TBC-48	Bright aluminum	12.8	48	47	24.75	24	21.25
TBC-48-BLK	Gloss black	12.8	48	47	24.75	24	21.25
TBC-48-DD*	Bright aluminum	11.1	48	47	20.75	20	21.25
TBC-60	Bright aluminum	16.7	61	60	24.75	24	21.25
TBC-60-BLK	Gloss black	16.7	61	60	24.75	24	21.25

* Designed to be used with cargo carrier #UWS-CARRIER

Utility Chest Mounting Kit

- Compatible with UWS utility chest boxes

Part#	Includes
003-CBOXMK	Two flange bolts, flat washers, and turn nuts

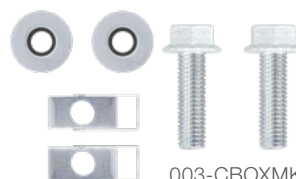

003-CBOXMK



TBC-48-DD shown in UWS-CARRIER

TRAILER TONGUE BOXES



Product Details

- Available for A-frame and straight-tongue trailers
- Patented RigidCore™ foam-filled lid maximizes strength and prevents binding
- 0.058" extra-thick, one-piece aluminum tub holds heavy tools and cargo
- Stainless steel lock handle for security and corrosion-resistant operation
- MicroSeal™ gasket helps seal out moisture, dust, and dirt
- Strut-actuated lid opens 90° for convenient operation and loading
- Low-profile option provides added clearance for a hand winch or other obstructions
- Mounting hardware sold separately



TBV-34



TBV-34-LP-BLK

Finishes & Material



Finish:
Bright aluminum

Material:
0.058" aluminum



Finish:
Gloss black

Material:
0.058" aluminum

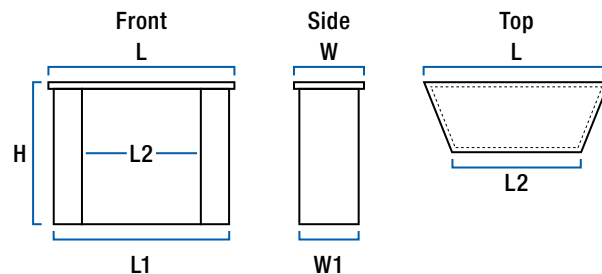

Part #	Finish	Cubic Feet	Dimensions (inches)					
			L	L1	L2	W	W1	H
TBV-34	Bright aluminum	4.1	34.75	33	20	17	16	22
TBV-34-BLK	Gloss black	4.1	34.75	33	20	17	16	22
TBV-34-LP	Bright aluminum	2.9	34.75	33	20	17	16	13
TBV-34-LP-BLK	Gloss black	2.9	34.75	33	20	17	16	13
TBV-49*	Bright aluminum	6.3	50	48	24	19	18	22
TBV-49-BLK*	Gloss black	6.3	50	48	24	19	18	22

* Intended for use on A-frame trailers only

Utility Chest Mounting Kit

- Compatible with UWS utility chest boxes

Part#	Includes
003-CBOXMK	Two flange bolts, flat washers, and turn nuts



003-CBOXMK



TOTE BOXES & FOOT LOCKERS



Tote Boxes

- Transportable and lockable to protect valuables at home, work, or in your vehicle
- 0.058" extra-thick, one-piece aluminum tub holds heavy tools and cargo
- Twist latch can accept a padlock to help secure box and its contents
- Top carry handle for easy transport



Foot Lockers

- Offers highly secure storage of tools, equipment, or personal items
- Patented RigidCore™ foam-filled lid maximizes strength and prevents binding
- 0.058" extra-thick, one-piece aluminum tub holds heavy tools and cargo
- Stainless steel lock handles for security and corrosion-resistant operation
- MicroSeal™ gasket helps seal out moisture, dust, and dirt
- Strut-actuated lid opens 90° for convenient operation and loading
- Side carry handles for easy transport
- Mounting hardware sold separately, see page 48



Finishes & Material

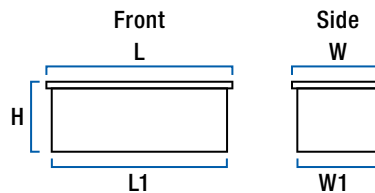
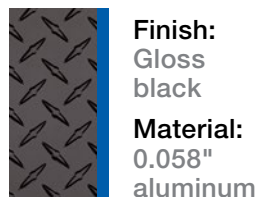
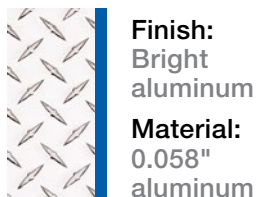

Part #	Finish	Cubic Feet	Dimensions (inches)				
			L	L1	W	W1	H
Tote Boxes							
TB-1	Bright aluminum	0.8	21	20	12.25	11.5	7
TB-2	Bright aluminum	1.3	21	20	12.25	11.5	11.25
Foot Lockers							
FOOT-LOCKER	Bright aluminum	4.8	36	35	20	19.25	13.25
FOOT-LOCKER-BLK	Gloss black	4.8	36	35	20	19.25	13.25





UTV & ATV TOOL BOXES

FEATURED PRODUCTS



UTV crossover tool boxes

These crossover-style tool boxes add secure storage to your UTV and install with vehicle-specific brackets.



UTV side mount tool boxes

This side tool box attaches to the bed wall of the UTV using vehicle-specific brackets, providing maximum storage, security, and organization.



ATV tool boxes

ATV tool boxes feature side handles for easy portability and can be mounted on virtually any ATV thanks to a universal design.

PRODUCT INDEX



56

UTV Crossover
Tool Boxes



56

UTV Side Mount
Tool Boxes



58

ATV
Tool Boxes

UTV TOOL BOXES



Product Details

- Mounts with vehicle-specific brackets for a custom fit
- Allows a UTV to transport cargo and keep tools on hand in the field
- Patented RigidCore™ foam-filled lid maximizes strength and prevents binding
- 0.058" extra-thick, one-piece aluminum tub holds heavy tools and cargo
- Stainless steel lock handles for security and corrosion-resistant operation
- MicroSeal™ gasket helps seal out moisture, dust, and dirt
- Strut-actuated lid opens 90° for convenient operation and loading
- Available in crossover and side-mount styles
- Crossover boxes and side-mount boxes may not fit together in the same UTV bed

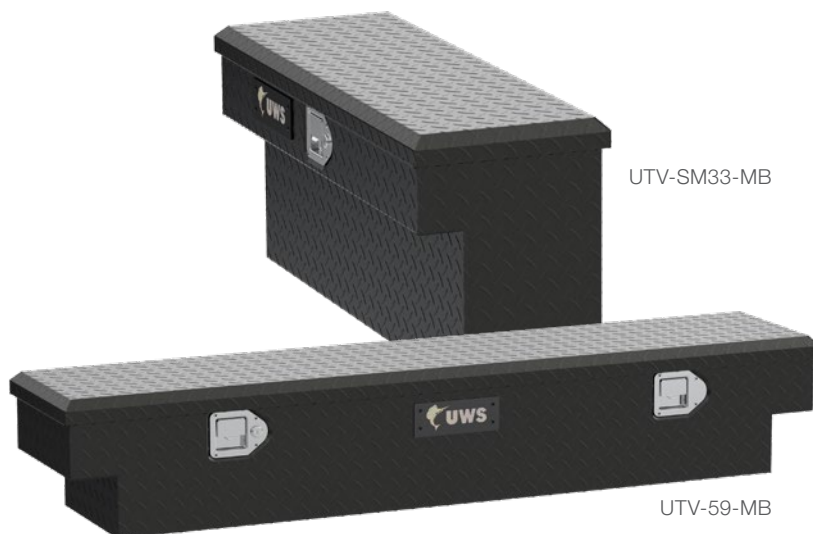

Finish & Material



Finish:
Matte black

Material:
0.058" aluminum

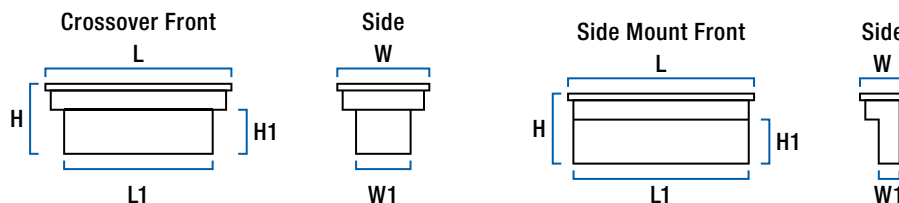

Make	Model / Style	Years	Kit (Box and Hardware)	Box Only	Hardware Only	Cu. Ft.	Dimensions (inches)					
			Kit #	Box #	Part #		L	L1	W	W1	H	H1
Crossover												
Can-Am	Defender full-size	16-24	8500002	UTV-59-MB	UTV-59CA	3.2	59.75	52	12.25	11.5	10.25	4.5
Honda	Pioneer 1000	17-24	8500004	UTV-59-MB	UTV-59HP*	3.2	59.75	52	12.25	11.5	10.25	4.5
Kawasaki	Mule Pro FXT	12-25	8500003	UTV-59-MB	UTV-59KM	3.2	59.75	52	12.25	11.5	10.25	4.5
Polaris	Ranger full-size	08-24	8500000	UTV-59-MB	UTV-59PR	3.2	59.75	52	12.25	11.5	10.25	4.5
	Ranger 1000 full-size	08-24	8500005	UTV-59PR-MB	UTV-59PR	3.2	59.75	52	12.25	11.5	10.25	4.5
Yamaha	Viking full-size	13-24	8500001	UTV-59-MB	UTV-59YV*	3.2	59.75	52	12.25	11.5	10.25	4.5
Side Mount												
Polaris	Ranger full-size	08-24	UTV-SM33-MB	--	Incl. in kit	2.45	34	33	12	8.5	15.25	9.5

*Continued while supplies last



ATV TOOL BOXES



Product Details

- Designed to mount on an ATV to transport cargo and keep tools on hand in the field
- Patented RigidCore™ foam-filled lid to maximize strength and prevent binding
- 0.058" extra-thick, one-piece aluminum tub holds heavy tools and cargo
- Stainless steel lock handles for security and corrosion-resistant operation
- MicroSeal™ gasket helps seal out moisture, dust, and dirt
- Strut-actuated lid opens 90° for convenient operation and loading
- Side carry handles for easy portability



Finishes & Material

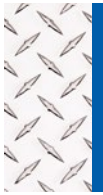

Finish:
Bright
aluminum

Material:
0.058"
aluminum



Finish:
Gloss
black

Material:
0.058"
aluminum

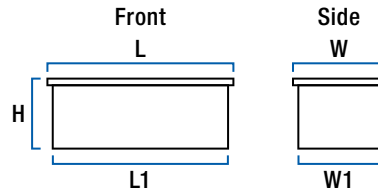

Part #	Finish	Cubic Feet	Dimensions (inches)				
			L	L1	W	W1	H
ATV	Bright aluminum	2.7	33	32	13	12	13.25
ATV-BLK	Gloss black	2.7	33	32	13	12	13.25





SIDE MOUNT BOXES

FEATURED PRODUCTS



Steel underbody boxes

Crafted from extra-thick, 14-gauge steel, these boxes can withstand the toughest conditions, ensuring your tools and cargo remain secure.



Adjustable truck bed legs

Telescoping legs attach almost anywhere on the truck bed wall and provide more room in the bed for cargo.



Low-profile side boxes

These truck side boxes have a low profile for better field of vision and enhanced safety, integrating with our low-profile crossover boxes.

PRODUCT INDEX



62

Topside
Tool Boxes



64

Truck Side
Tool Boxes



65

Space-Saving
Truck Bed Legs



66

Wheel Well
Tool Boxes



68

Underbody
Tool Boxes

TOPSIDE TOOL BOXES



Product Details

- Mounts on top of truck bed rail for easy cargo and tool access
- Stainless steel aircraft cables for strong door support
- 0.058" extra-thick, one-piece aluminum tub holds heavy tools and cargo
- Strut-actuated lid opens 90° for convenient operation and loading
- Stainless steel T-handles for security and corrosion resistance
- MicroSeal™ gasket helps seal out moisture, dust, and dirt
- Multiple box sizes with large open bay storage compartment
- Available in single and double-door models
- Mounting hardware not included



TBTS-48

TBTS-72-BLK

Finishes & Material



Finish:
Bright
aluminum

Material:
0.058"
aluminum



Finish:
Gloss
black

Material:
0.058"
aluminum

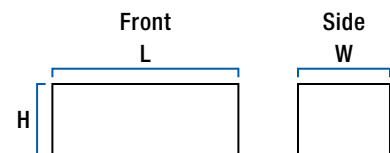

Part #	Finish	Cubic Feet	# of Doors	Door Opening Dims (in.)		Box Dimensions (inches)		
				L	H	L	W	H
TBTS-48	Bright aluminum	6.3	1	42.5	12	48	13.75	17
TBTS-48-BLK	Gloss black	6.3	1	42.5	12	48	13.75	17
TBTS-60	Bright aluminum	7.8	1	55.5	12	60	13.75	17
TBTS-60-BLK	Gloss black	7.8	1	55.5	12	60	13.75	17
TBTS-72	Bright aluminum	9.4	2	30.5	12	72	13.75	17
TBTS-72-BLK	Gloss black	9.4	2	30.5	12	72	13.75	17
TBTS-90	Bright aluminum	11.7	2	39.5	12	90	13.75	17
TBTS-90-BLK	Gloss black	11.7	2	39.5	12	90	13.75	17
TBTS-96	Bright aluminum	12.5	2	42.5	12	96	13.75	17
TBTS-96-BLK	Gloss black	12.5	2	42.5	12	96	13.75	17



TRUCK SIDE TOOL BOXES



Product Details

- Mounts on the inside of the truck bed rails to provide additional storage space
- Patented RigidCore™ foam-filled lid maximizes strength and prevents binding
- 0.058" extra-thick, one-piece aluminum tub holds heavy tools and cargo
- Universal design can be mounted on the driver or passenger side
- Low profile provides better field of vision for enhanced safety
- Stainless steel, lockable paddle handles for easy operation (standard models only)
- Stainless steel, lockable push-button operation (low-profile models only)
- Mounting hardware not included



TBSM-36
(legs ship unattached)

TBSM-36-LP-BLK
(legs ship unattached)

Finishes & Material



Finish:
Bright
aluminum

Material:
0.058"
aluminum



Finish:
Gloss
black

Material:
0.058"
aluminum

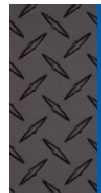

Finish:
Matte
black

Material:
0.058"
aluminum

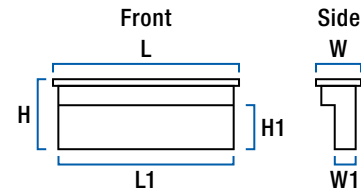

Part #	Profile	Finish	Cubic Feet	Dimensions (inches)					
				L	L1	W	W1	H	H1
TBSM-36	Standard	Bright aluminum	2.2	37	36	12	7	12	6.5
TBSM-36-BLK	Standard	Gloss black	2.2	37	36	12	7	12	6.5
TBSM-36-LP	Low	Bright aluminum	2.3	36.75	36	14.5	9.25	11.75	8.75
TBSM-36-LP-BLK	Low	Gloss black	2.3	36.75	36	14.5	9.25	11.75	8.75
TBSM-36-LP-MB	Low	Matte black	2.3	36.75	36	14.5	9.25	11.75	8.75
TBSM-48	Standard	Bright aluminum	3	49	48	12	7	12	6.5
TBSM-48-BLK	Standard	Gloss black	3	49	48	12	7	12	6.5
TBSM-48-LP	Low	Bright aluminum	3	48.75	48	14.5	9.25	11.75	8.75
TBSM-48-LP-BLK	Low	Gloss black	3	48.75	48	14.5	9.25	11.75	8.75
TBSM-48-LP-MB	Low	Matte black	3	48.75	48	14.5	9.25	11.75	8.75
TBSM-60	Standard	Bright aluminum	3.7	61	60	12	7	12	6.5
TBSM-60-BLK	Standard	Gloss black	3.7	61	60	12	7	12	6.5
TBSM-72	Standard	Bright aluminum	4.2	73	72	12	7	12	6.5
TBSM-72-BLK	Standard	Gloss black	4.2	73	72	12	7	12	6.5

Select kitted options available with space-saving legs (see uwsta.com)



SPACE-SAVING TRUCK BED LEGS

Adjustable Legs for Truck Side Boxes (sold separately)

- Improved mounting system for truck side tool boxes
- Space-saving design provides more room in the truck bed for cargo
- Can be mounted anywhere on the side box or truck bed, as needed
- Mount at any angle between 0° and 55°
- Gloss black powder-coated steel construction with clear zinc hardware
- Not compatible with topside boxes



TBSM-MK2



Part #	Includes
TBSM-MK2	Two legs, installation hardware, and rivet nut tool

WHEEL WELL TOOL BOXES



Product Details

- Integrates with the wheel well fender to provide convenient storage space
- Patented RigidCore™ foam-filled lid maximizes strength and prevents binding
- 0.058" extra-thick, one-piece aluminum tub holds heavy tools and cargo
- Three sliding drawers open toward the rear for storage of tools and equipment
- Corrosion-resistant zinc-plated metal sliders ensure long life
- Stainless steel ball bearings for smooth operation
- Stainless steel lock handle for security and corrosion-resistant operation
- MicroSeal™ gasket helps seal out moisture, dust, and dirt
- Lid opens 90° for convenient operation and loading
- Available for driver and passenger side
- Mounting hardware not included



Finishes & Material

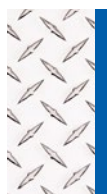

Finish:
Bright
aluminum

Material:
0.058"
aluminum



Finish:
Gloss
black

Material:
0.058"
aluminum

Drawer
Front



Drawer
Side

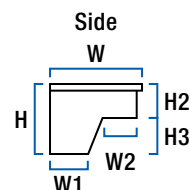

Front



Part #	Finish	Vehicle Side	Cu. Ft.	Drawer Dims (inches)				Box Dimensions (inches)							
				L	W	H	Drawer Count	L	L1	W	W1	W2	H	H2	H3
FW-48-DS-P	Bright alum.	Pass.	3.9	4.5	15	3	1	8.75	8	48	18	20.25	24.75	13	11.75
				4.5	15	2	2								
FW-48-DS-P-BLK	Gloss black	Pass.	3.9	4.5	15	3	1	8.75	8	48	18	20.25	24.75	13	11.75
				4.5	15	2	2								
FW-48-DS-D	Bright alum.	Driver	3.9	4.5	15	3	1	8.75	8	48	18	20.25	24.75	13	11.75
				4.5	15	2	2								
FW-48-DS-D-BLK	Gloss black	Driver	3.9	4.5	15	3	1	8.75	8	48	18	20.25	24.75	13	11.75
				4.5	15	2	2								

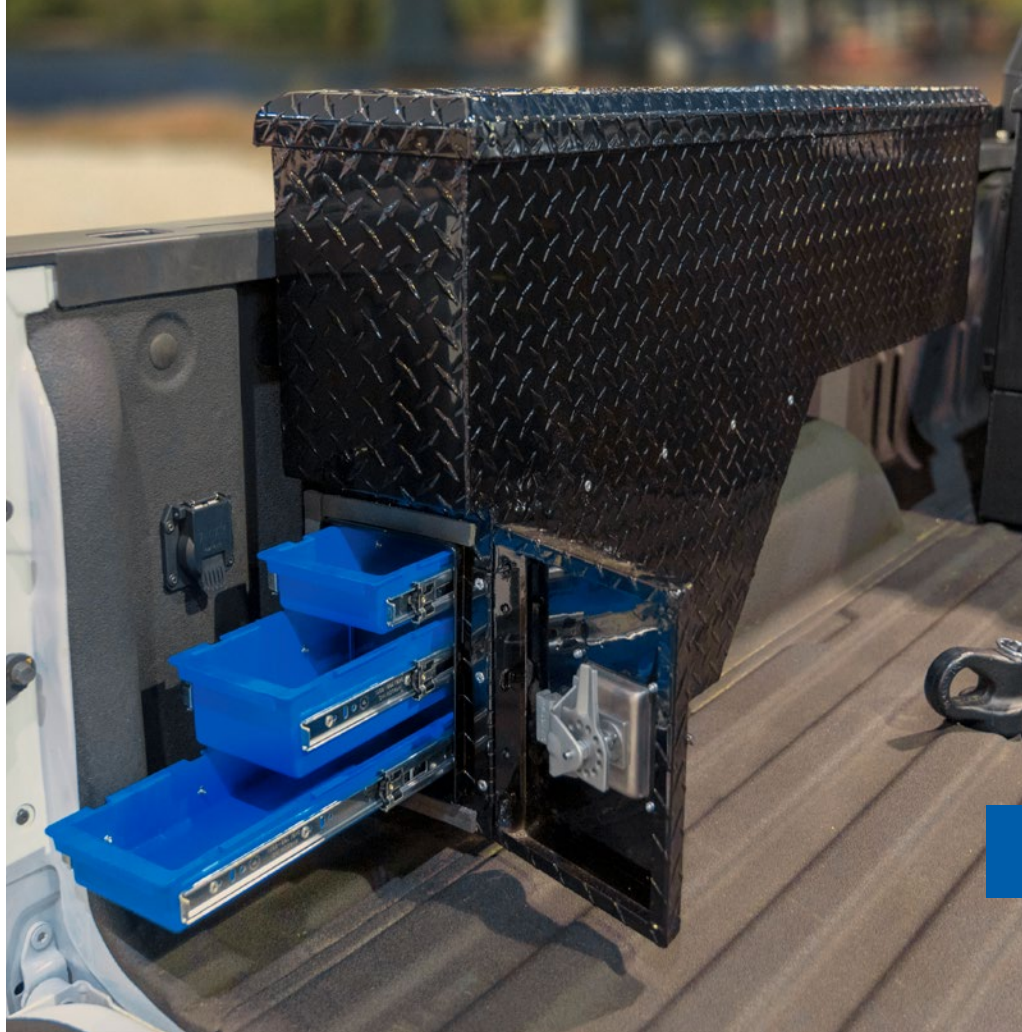

UNDERBODY TOOL BOXES



Product Details

- Mounts above or below flatbeds, dump trucks, and trailer bodies
- Stainless steel cables for strong door support
- Door opens 90° for easy loading and unloading of tools and equipment
- Stainless steel T-handles for security and corrosion resistance
- MicroSeal™ gasket helps seal out moisture, dust, and dirt
- Large open-bay storage compartment with single and double-door options for flexibility
- 1" drip rail completely encompasses door opening to resist water infiltration
- Mounting hardware not included
- Available in lightweight aluminum or high-strength steel construction



TBUB-72

TBUB-36-BLK

NEW



ST-TBUB-60

NEW

ST-TBUB-30

Finishes & Material

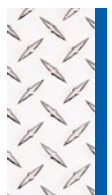

Finish:
Bright aluminum
Material:
0.075" aluminum



Finish:
Gloss black
Material:
0.075" aluminum



Finish:
Matte black
Material:
14-gauge steel

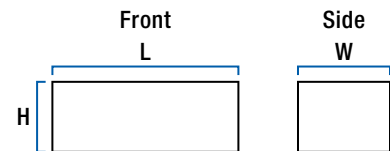

Part #	Finish	Cubic Feet	# of Doors	Door Opening Dims (in.)		Box Dimensions (inches)		
				L	H	L	W	H
Aluminum Boxes								
TBUB-24	Bright aluminum	4.6	1	19.5	13	24	19	18
TBUB-30	Bright aluminum	5.7	1	25.5	13	30	19	18
TBUB-36	Bright aluminum	6.9	1	31.5	13	36	19	18
TBUB-36-BLK	Gloss black	6.9	1	31.5	13	36	19	18
TBUB-48	Bright aluminum	9.2	1	43.5	13	48	19	18
TBUB-60	Bright aluminum	11	1	55.5	13	60	19	18
TBUB-72	Bright aluminum	12.9	2	30.5	13	72	19	18
TBUB-96	Bright aluminum	17.2	2	42.5	13	96	19	18
Steel Boxes								
ST-TBUB-24-MB	Matte black	4.6	1	19.5	13	24	19	18
ST-TBUB-30-MB	Matte black	5.7	1	25.5	13	30	19	18
ST-TBUB-36-MB	Matte black	6.9	1	31.5	13	36	19	18
ST-TBUB-48-MB	Matte black	9.2	1	43.5	13	48	19	18
ST-TBUB-60-MB	Matte black	11	1	55.5	13	60	19	18



RELIABLE UNDERBODY BOX MOUNTING

Mounting Brackets

- 18" x 18" L-bracket design provides dependable installation of underbody box
- Ideal for box installation on flatbeds, dump trucks, and trailer bodies
- Fits any UWS or 18" deep x 18" tall aftermarket underbody tool box
- Strong steel construction with durable powder coat finish
- Brackets can be welded or bolted on



TBUB-1818-LB

Part #	Fits	Includes
TBUB-1818-LB	18" x 18" underbody tool boxes	Two brackets, four 3" bolts, washers, and locknuts



DRAWER BOXES

FEATURED PRODUCTS



Utility chest with drawers

Our enhanced utility chest provides the ultimate in secure storage and organization, featuring a large center compartment and built-in drawers.



Drawer tool boxes

Great for a variety of applications, these boxes have five integrated sliding drawers with stainless steel sliders for long-lasting operation.



Wheel well tool boxes

Available for driver and passenger sides, wheel well boxes feature three integrated sliding drawers. [See page 66 for more information.](#)

PRODUCT INDEX



72

Utility Chest Box
with Drawers



74

Drawer Truck
Tool Boxes



66

Wheel Well
Tool Boxes

UTILITY CHEST BOXES WITH DRAWERS



Product Details

- Ten precision-injected drawers for storage of small tools
- Stainless steel, ball bearing drawer slides for smooth operation
- Patented RigidCore™ foam-filled lid to maximize strength and prevent binding
- 0.058" extra-thick, one-piece aluminum tub holds heavy tools and cargo
- Stainless steel lock handle for security and corrosion-resistant operation
- Front and top opening lids for easy access to tools and equipment
- Strut-actuated lid opens 90° for convenient operation and loading
- Removable, three-compartment sliding tray for convenient small item storage and retrieval
- Carrying handles on the sides for easy portability
- Mounting hardware sold separately



TBC-38-DS

TBC-38-DS-BLK

Finishes & Material



Finish:
Bright aluminum

Material:
0.058" aluminum



Finish:
Gloss black

Material:
0.058" aluminum

Drawer Front



Drawer Side



Box Front

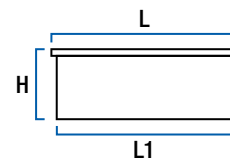

Box Side

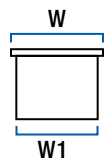

Part #	Finish	Cubic Feet	Drawer Dimensions (inches)				Chest Dimensions (inches)				
			L	W	H	Drawer Count	L	L1	W	W1	H
TBC-38-DS	Bright aluminum	4 (center)	4.5	19	2	4	38	37	23	22	20
			4.5	19	3	6					
TBC-38-DS-BLK	Gloss black	4 (center)	4.5	19	2	4	38	37	23	22	20
			4.5	19	3	6					

Mounting Kit

- Compatible with UWS utility chest boxes

Part #	Includes
003-CBOXMK	Two flange bolts, flat washers, and turn nuts



003-CBOXMK



DRAWER TRUCK TOOL BOXES



Product Details

- Five precision-injected, commercial-grade drawers for secure storage
- Stainless steel T-handle lock for security and corrosion resistance
- Provides easier access to small tools and equipment
- Integrated drawer design provides maximum security and organization
- Stainless steel, ball bearing drawer slides for smooth operation
- MicroSeal™ gasket helps seal out moisture, dust, and dirt
- Basic hardware included for easy mounting on trucks, vans, trailers, or workbenches

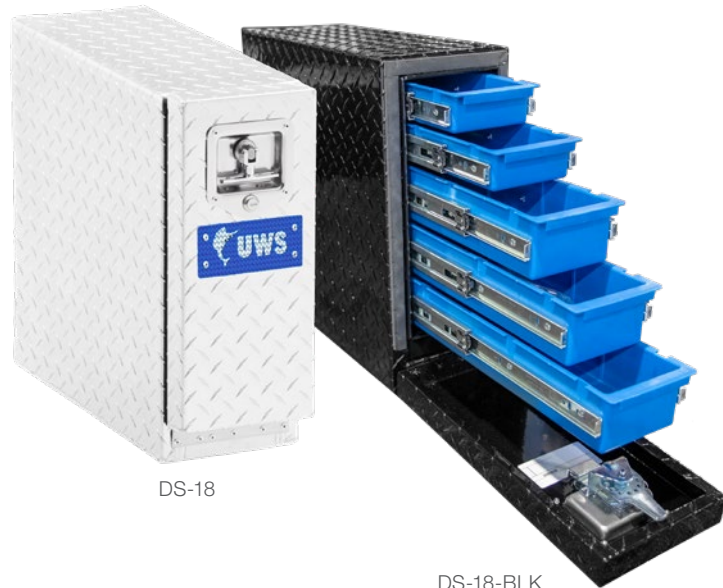

DS-18

DS-18-BLK

Finishes & Material

Finish:
Bright aluminum

Material:
0.058" aluminum

Finish:
Gloss black

Material:
0.058" aluminum

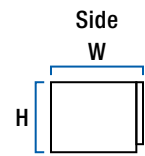
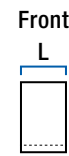
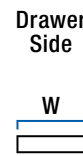

Part #	Finish	Cubic Feet	Drawer Dimensions (in.)				Box Dimensions (inches)		
			W	L	H	Drawer Count	W	L	H
DS-18	Bright aluminum	1.5	15	4.5	2	2	18	7.75	18.75
			15	4.5	3	3			
DS-18-BLK	Gloss black	1.5	15	4.5	2	2	18	7.75	18.75
			15	4.5	3	3			
DS-22	Bright aluminum	1.9	19	4.5	2	2	22	7.75	18.75
			19	4.5	3	3			
DS-22-BLK	Gloss black	1.9	19	4.5	2	2	22	7.75	18.75
			19	4.5	3	3			

Mounting Kit

- Compatible with UWS drawer boxes and utility chests



Part #	Includes
003-CBOXMK	Two flange bolts, flat washers, and turn nuts

003-CBOXMK





Scan QR code for instructions on measuring a truck bed for a tool box or transfer tank

TRANSFER TANKS

FEATURED PRODUCTS



Rectangular tanks

Rectangular tanks are available in various sizes, including 24" square models, to accommodate many different types of truck beds.



Hammerhead-style tanks

These tanks feature a narrowed base, making them a universal fit for all full-size trucks. Available in both L-shape and combo styles.



Steel-aluminum combo tanks

These combo tanks are an industry first, featuring a dual construction of steel and aluminum to weigh less than competitive, full-steel models.

PRODUCT INDEX



78

Transfer Tank
Overview



80

Hammerhead-
Style Tanks



82

Combo
Tanks



84

L-Shaped
Tanks



86

Rectangular
Tanks

Tanks are DOT-compliant for transporting Class 3 combustible fuels only, such as diesel.

TRANSFER TANK OVERVIEW



Product Details

- Transfers diesel or other non-flammable liquids to on-site vehicles or equipment
- Lockable, commercial-grade vented cap with reinforced collar for added security (replacement cap #UWS-CAPS)
- Internal baffles for extra strength and a smooth, even flow of liquid
- Built-in 3/8" drain plug for easy and complete emptying as needed
- 100% of tanks are pressure tested for safety
- Integrated tabs for solid installation
- Unique, smooth finish on steel tanks and rugged diamond plate on aluminum
- Two built-in hooks make it easy to lift in and out of the truck (steel tanks only)
- Multiple tank capacities and styles available for a custom fit on each truck application
- Mounting hardware not included



ST-100HH-CB-MB

TT-50-LT-P

Style Options

Hammerhead



Narrow base fits all full-size trucks, including short bed

Combo



Built-in tool box adds storage without reducing truck bed space

L-shaped



L-shaped tank allows space for a crossover truck tool box

Rectangular



Mounts behind the truck cab, leaving the bed open for cargo

Finishes & Materials

Steel tanks (tool box applies to combo tanks only)

Finish:
Matte black

Tank material:
14-gauge steel

Tool box material:
0.080" aluminum

Finish:
Semi-gloss white

Tank material:
14-gauge steel

Tool box material:
0.080" aluminum

Aluminum tanks

Finish:
Bright aluminum

Material:
0.125" aluminum

Finish:
Gloss black

Material:
0.125" aluminum



KEY FEATURES OF COMBO TANKS



Built-in tool box adds storage without reducing truck bed space



Patented RigidCore™ foam-filled lid adds strength and prevents binding



Stainless steel lock handles allow operation from either side



Strut-actuated lid opens 90° for convenient operation

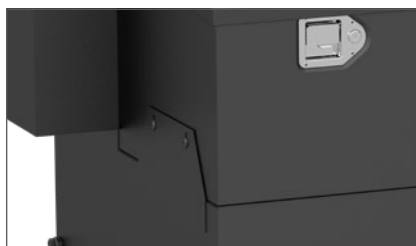

Thru-bolted tool box with neoprene washers for water resistance



Interior rod enclosure helps prevent bending or jamming of lock system

Tanks are DOT-compliant for transporting Class 3 combustible fuels only, such as diesel.

HAMMERHEAD-STYLE TANKS



Key Features

- Fits all full-size trucks, including short bed, with narrow base to fit between wheel wells
- Industry-first steel-aluminum combo tanks weigh less than full-steel tanks
- See page 78 for a full list of product details



ST-100HH-CB-MB

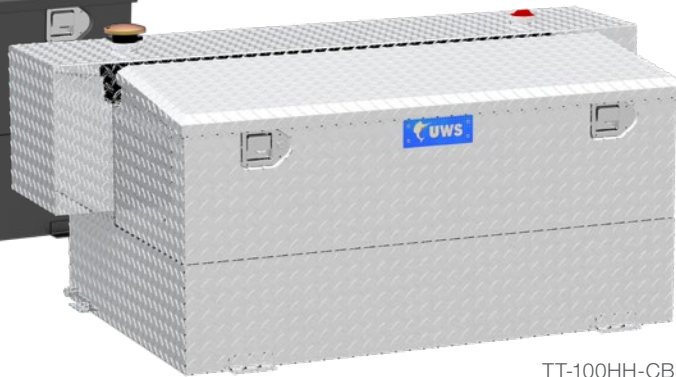

TT-100HH-CB



TT-100HH-B



ST-100HH-W

Finishes & Materials

Steel tanks (tool box applies to combo tanks only)

Finish:
Matte black

Tank material:
14-gauge steel

Tool box material:
0.080" aluminum

Finish:
Semi-gloss white

Tank material:
14-gauge steel

Tool box material:
0.080" aluminum

Aluminum tanks

Finish:
Bright aluminum

Material:
0.125" aluminum

Finish:
Gloss black

Material:
0.125" aluminum

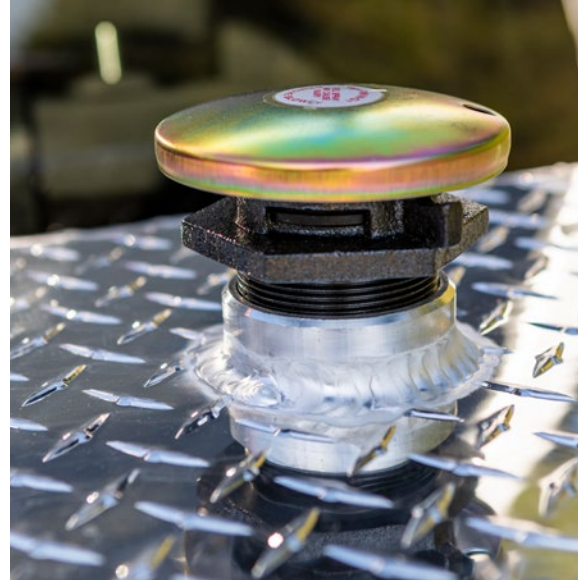

Combo, Angled Front
L

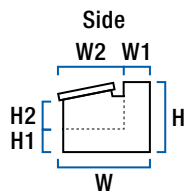
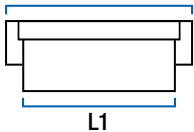

L-Shaped Front
L

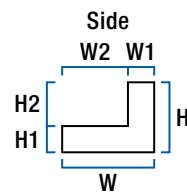
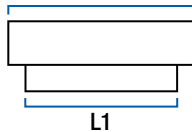

Part #	Finish & Material	Gal.	Angled Lid	Cu. Ft.	Dimensions (inches)							
					L*	L1	W	W1	W2	H**	H1	H2
Combo Tanks												
ST-100HH-CB-MB	Matte black steel / aluminum	100	Yes	6.5	59	48	31	13	18	24.75	9.75	13
ST-100HH-CB-W	Semi-gloss white steel / alum.	100	Yes	6.5	59	48	31	13	18	24.75	9.75	13
TT-100HH-CB	Bright aluminum	100	Yes	6.5	59	48	31	13	18	24.75	9.75	13
TT-100HH-CB-B	Gloss black aluminum	100	Yes	6.5	59	48	31	13	18	24.75	9.75	13
L-Shaped Tanks												
ST-100HH-MB	Matte black steel	100	--	--	59	48	31	13	18	24.75	9.75	15
ST-100HH-W	Semi-gloss white steel	100	--	--	59	48	31	13	18	24.75	9.75	15
TT-100HH	Bright aluminum	100	--	--	59	48	31	13	18	24.75	9.75	15
TT-100HH-B	Gloss black aluminum	100	--	--	59	48	31	13	18	24.75	9.75	15

* Add 3" to dimension (L) for mounting bracket clearance

** Add 2-3/4" to dimension (H) for vent cap clearance

COMBO TANKS



Key Features

- Built-in tool box provides added storage without reducing truck bed space
- Patented RigidCore™ foam-filled lid maximizes strength and prevents binding
- Industry-first steel-aluminum combo weighs less than full-steel models
- See page 78 for a full list of product details



ST-100-COMBO-MB



ST-75-COMBO-W



TT-85-COMBO-BLK



TT-85-COMBO

Finishes & Materials

Steel tanks

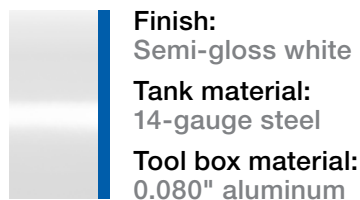
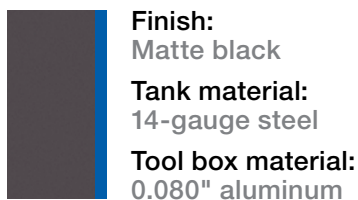

Aluminum tanks

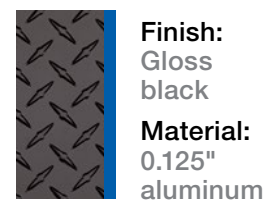

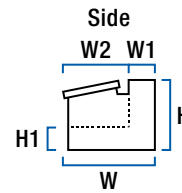
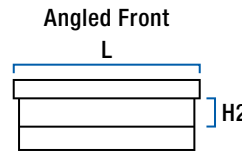
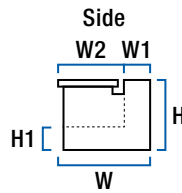
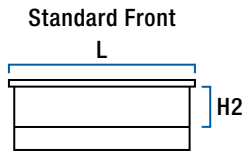

Part #	Finish	Gallons	Angled Lid	Cubic Feet	Dimensions (inches)						
					L*	W	W1	W2	H**	H1	H2
Steel-Aluminum Tanks											
ST-75-COMBO-W	Semi-gloss white	75	Yes	6.5	48.5	27	9	18	24	9	15
ST-75-COMBO-MB	Matte Black	75	Yes	6.5	48.5	27	9	18	24	9	15
ST-85-COMBO-W	Semi-gloss white	85	No	12	48.25	34	10	24	26	8	18
ST-85-COMBO-MB	Matte Black	85	No	12	48.25	34	10	24	26	8	18
ST-100-COMBO-W	Semi-gloss white	100	No	11.4	60	31	9	22	24	9	15
ST-100-COMBO-MB	Matte Black	100	No	11.4	60	31	9	22	24	9	15
Aluminum Tanks											
TT-45-COMBO	Bright aluminum	45	Yes	3.4	55	18.5	6	12	20.25	8	9
TT-45-COMBO-BLK	Gloss black	45	Yes	3.4	55	18.5	6	12	20.25	8	9
TT-50-COMBO	Bright aluminum	50	No	7	37	32.5	8	24	22.5	8	14.25
TT-50-COMBO-BLK	Gloss black	50	No	7	37	32.5	8	24	22.5	8	14.25
TT-75-COMBO	Bright aluminum	75	Yes	6.5	49	27.5	9	18	24	9	13
TT-75-COMBO-BLK	Gloss black	75	Yes	6.5	49	27.5	9	18	24	9	13
TT-85-COMBO	Bright aluminum	85	No	12	48.5	34.25	10	24	26.5	8	18
TT-85-COMBO-BLK	Gloss black	85	No	12	48.5	34.25	10	24	26.5	8	18
TT-100-COMBO	Bright aluminum	100	No	11.4	60.25	31.25	9	22	24.5	9	15
TT-100-CB-B	Gloss black	100	No	11.4	60.25	31.25	9	22	24.5	9	15

* Add 3" to dimension (L) for mounting bracket clearance

** Add 2-3/4" to dimension (H) for vent cap clearance

L-SHAPED TANKS



Key Features

- L-shaped tank allows space for a truck tool box
- Lockable, commercial-grade vented cap with reinforced collar for added security
- See page 78 for a full list of product details



ST-100-L-MB

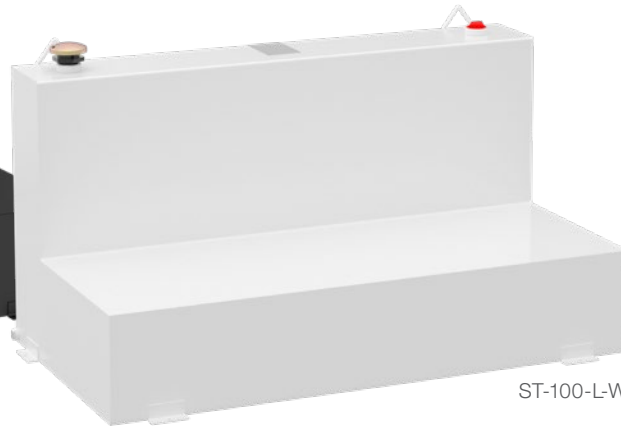

ST-100-L-W



TT-50-L-T-P-BLK



TT-50-L-T-P

Finishes & Materials

Steel tanks

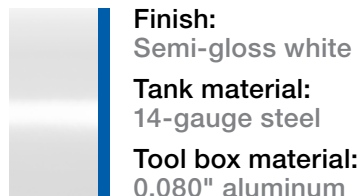
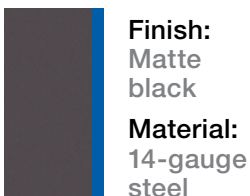

Aluminum tanks

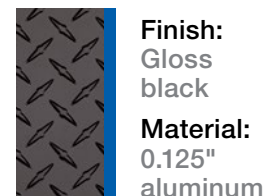
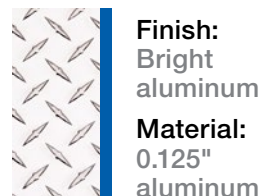

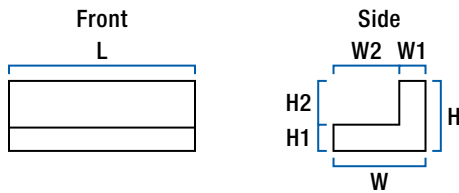

Part #	Finish	Gallons	Dimensions (inches)						
			L*	W	W1	W2	H**	H1	H2
Steel Tanks									
ST-75-L-W	Semi-gloss white	75	48	27	9	18	24	9	15
ST-75-L-MB	Matte black	75	48	27	9	18	24	9	15
ST-85-L-W	Semi-gloss white	85	48	34	10	24	26	8	18
ST-85-L-MB	Matte black	85	48	34	10	24	26	8	18
ST-100-L-W	Semi-gloss white	100	59.5	31	9	22	24	9	15
ST-100-L-MB	Matte black	100	59.5	31	9	22	24	9	15
Aluminum Tanks									
TT-50-L-T-P	Bright aluminum	50	36.25	32	8	24	22	8	14
TT-50-L-T-P-BLK	Gloss black	50	36.25	32	8	24	22	8	14
TT-75-L-T-P	Bright aluminum	75	48	27	9	18	24	9	15
TT-75-L-T-P-BLK	Gloss black	75	48	27	9	18	24	9	15
TT-85-L-T-P	Bright aluminum	85	48	34	10	24	26	8	18
TT-85-L-T-P-BLK	Gloss black	85	48	34	10	24	26	8	18
TT-100-L-T-P	Bright aluminum	100	59.5	31	9	22	24	9	15
TT-100-L-T-P-BLK	Gloss black	100	59.5	31	9	22	24	9	15

* Add 3" to dimension (L) for mounting bracket clearance

** Add 2-3/4" to dimension (H) for vent cap clearance

RECTANGULAR TANKS



Key Features

- Mounts behind the truck cab, leaving the bed open for cargo
- Compatible with most short-bed trucks and gooseneck hitches (select models)
- See page 78 for a full list of product details

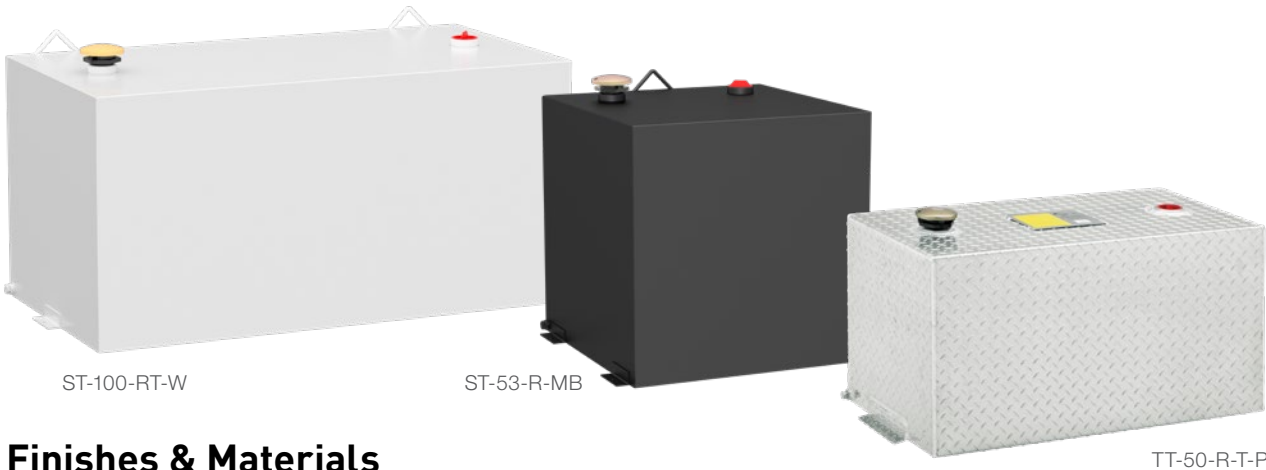

Finishes & Materials

Steel tanks

Finish:
Matte black

Material:
14-gauge steel

Finish:
Semi-gloss white

Material:
14-gauge steel

Aluminum tanks

Finish:
Bright aluminum

Material:
0.125" aluminum

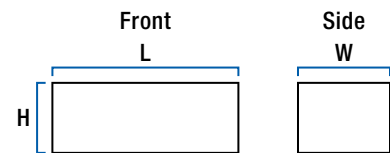

Part #	Finish	Gallons	Dimensions (inches)		
			L*	W	H**
Steel Tanks					
ST-45-R-W	Semi-gloss white	45	54	10.5	19.5
ST-45-R-MB	Matte black	45	54	10.5	19.5
ST-53-R-W*	Semi-gloss white	53	24	24	24
ST-53-R-MB*	Matte black	53	24	24	24
ST-100-RT-W*	Semi-gloss white	100	47	24	23
ST-100-RT-MB*	Matte black	100	47	24	23
Aluminum Tanks					
TT-45-R-T-P	Bright aluminum	45	54	10.5	19.5
TT-50-R-T-P*	Bright aluminum	50	36	19	19
TT-100-RT-T-P*	Bright aluminum	100	47	24	23

* Add 3" to dimension (L) for mounting bracket clearance

** Add 2-3/4" to dimension (H) for vent cap clearance

* Indicates short-bed and gooseneck compatibility





DOG BOXES

FEATURED PRODUCTS



Southern dog boxes

These dog boxes have open rungs for ventilation and are available with single or double doors. Both styles feature a top tie-down rail.



Northern dog box

This double-door dog box features enclosed walls to help protect from wind and cold temps. It is also equipped with a top storage chest.



Accessory box

This 34" wide box fits perfectly into the top of our dog boxes, providing secure storage of collars, training dummies, and other accessories.

PRODUCT INDEX



90
Southern
Dog Boxes



91
Dog Box
Accessory



92
Northern
Dog Box

SOUTHERN DOG BOXES



Product Details

- Premium design to transport your dogs and dog equipment safely and securely
- Open bottom and wide-spaced rungs for consistent airflow and easy cleaning
- Rail provides a reliable anchor for tying down cargo on top
- 0.058" one-piece aluminum to be strong, lightweight, and corrosion-resistant
- Stainless steel lock handle for security and corrosion-resistant operation
- Interior divider provides separate compartments for two dogs (#DB-4848)
- Mounting hardware not included



DB-3636

Finish & Material



Finish:
Bright aluminum

Material:
0.058" aluminum



DB-4848

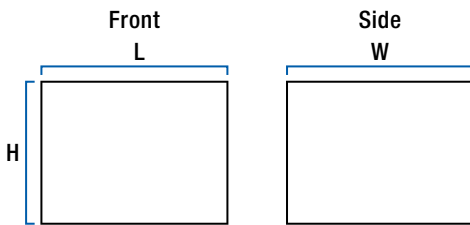

Part #	Finish	Cubic Feet	# of Doors	Door Opening Dims (in.)		Box Dimensions (inches)		
				L	H	L	W	H
DB-3636	Bright aluminum	18	1	18.5	21	36	36	24
DB-4848	Bright aluminum	32	2	17.25	21	48	48	24



ACCESSORY BOX

- Storage box designed for securing dog tracking collars and other small items
- Suitable for mounting on truck-based dog box or other surfaces (hardware not included)
- Patented RigidCore™ foam-filled lid to maximize strength and prevent binding
- 0.058" extra-thick, one-piece aluminum tub can hold heavy tools or cargo
- Beveled lid limits sharp edges and makes it easy to open
- Stainless steel lock handle for security and corrosion-resistant operation
- MicroSeal™ gasket helps seal out moisture, dust, and dirt
- Strut-actuated lid opens 90° for convenient operation and loading

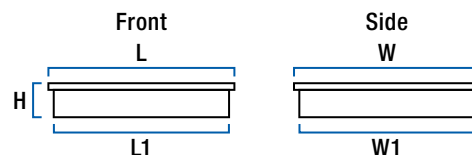

Part #	Finish	Cu. Feet	Dimensions (inches)				
			L	L1	W	W1	H
TCB-34	Bright alum.	3.4	32	31	35	34	6.75

NORTHERN DOG BOX



Product Details

- Premium design to transport your dogs and dog equipment safely and securely
- Enclosed walls and bottom help keep dogs warm and protected from the elements
- Rail provides a reliable anchor for tying down cargo on top
- 0.058" one-piece aluminum to be strong, lightweight, and corrosion-resistant
- Stainless steel lock handles for security and corrosion-resistant operation
- Built-in tool box provides added storage without reducing truck bed space
- Patented RigidCore™ foam-filled lid to maximize strength and prevent binding
- MicroSeal™ gasket helps seal out moisture, dust, and dirt
- Self-opening lid automatically opens for convenience when hands are full
- Cleanout ports at the back of each compartment for easy cleaning
- Mounting hardware not included



Finish & Material



Finish:
Bright aluminum

Material:
0.058" aluminum

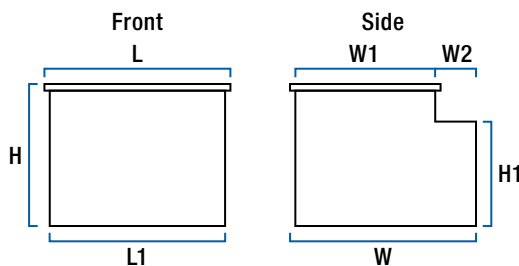

Part #	Finish	Cu. Feet	# of Doors	Door Opening Dims (in.)		Dimensions (inches)						
				L	H	L	L1	W	W1	W2	H	H1
DB-4848N	Bright aluminum	35.2	2	15.75	17.5	48	47.25	48.25	34.75	13.75	28.25	23





ACCESSORIES

FEATURED PRODUCTS



Cargo carrier

This lightweight aluminum cargo carrier mounts easily onto any 2" hitch receiver and provides extra storage with a 500-lb.



Tote boxes

UWS tote boxes feature a top carry handle and are fully lockable thanks to a twist latch that accepts a padlock.



Replacement parts

We offer a wide variety of replacement parts for our crossover tool boxes, utility chests, transfer tanks, and much more.

PRODUCT INDEX

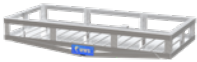

96
Cargo
Carrier



97
Tie
Downs



97
Tote
Boxes



98
Replacement
Parts

CARGO CARRIER



Product Details

- Mounts onto any 2" x 2" receiver tube opening (hitch pin not included)
- Rated to carry loads up to 500 lbs.
- Fully welded 0.058" aluminum construction with heavy-duty beam platform
- Optional chest #TBC-48-DD provides lockable, weatherproof rear hitch storage (see below)



UWS-CARRIER

Finish & Material



Finish:
Bright aluminum

Material:
0.058" aluminum

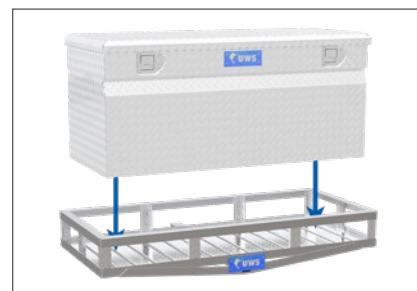
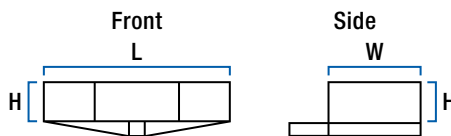

Accepts TBC-48-DD utility chest box

Part #	Finish	Capacity	Outside Dimensions (inches)			Inside Dimensions (inches)		
			L	W	H	L	W	H
UWS-CARRIER	Bright aluminum	500 lbs.	51	23	6.38	48.25	20.25	6.5

Utility Chest Box

- Fits perfectly into the #UWS-CARRIER
- Patented RigidCore™ foam-filled lid
- 0.058" extra-thick, one-piece aluminum tub
- Stainless steel lock handles for security
- [See page 48 for more information](#)

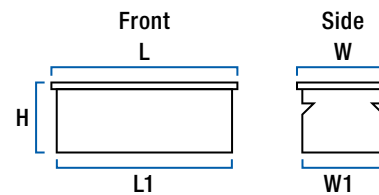

Part #	Finish	Box Weight	Cubic Feet	Dimensions (inches)				
				L	L1	W	W1	H
TBC-48-DD	Bright aluminum	39.6 lbs.	11.1	48	47	20.75	20	21.25

CROSSOVER BOX TIE DOWNS

NEW

Product Details

- Integrated tie-down rails for enhanced cargo management and security
- Robust look and feel to set your truck tool box apart
- Black UV-stabilized, glass-filled nylon construction
- Great add-on upgrade for an existing tool box

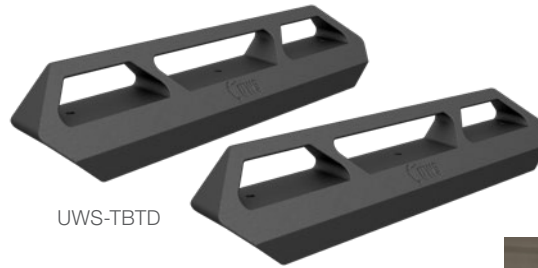

UWS-TBTD



Mounts onto any standard crossover box to provide a stable anchor point to secure cargo

Part #	Capacity	Dimensions (inches)		
		L	W	H
UWS-TBTD	50 lbs.	18.125"	2.75"	3.5"

TOTE BOXES



Product Details

- Transportable and lockable to protect valuables at home, work, or in your vehicle
- 0.058" extra-thick, one-piece aluminum tub holds heavy tools and cargo
- Twist latch accepts a padlock to help secure contents
- Top carry handle for easy portability



TB-2

TB-1

Finish & Material



Finish:
Bright aluminum

Material:
0.058" aluminum

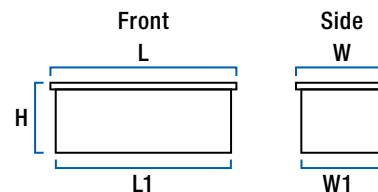

Part #	Finish	Cubic Feet	Dimensions (inches)				
			L	L1	W	W1	H
TB-1	Bright aluminum	0.8	21	20	12.25	11.5	7
TB-2	Bright aluminum	1.3	21	20	12.25	11.5	11.25

REPLACEMENT PARTS



003-CH503CYLNDR



003-HDL



003-HDNL



UWS-NHPIN



003-SLLKBLK



003-002LC



UWS-LOCKING



UWS-NONLOCKING



UWS-THLOCK



UWS-TWISTLOCK



003-NHPIN



UWS-SBRACKET



UWS-TCA



UWS-BALL-STUD



UWS-JBOLTKIT



UWS-ROD-CONNECT



UWS-CAPS



UWS-LIFT-CYLIND

Part #	Description	Fits
003-CBOXMK	Chest box mounting kit	All utility chest boxes
003-CH501CYLNDR	Lock cylinder and keys	Paddle handle boxes
003-CH502CYLNDR	Lock cylinder and keys	Paddle handle boxes
003-CH503CYLNDR	Lock cylinder and keys	Paddle handle boxes
003-CH504CYLNDR	Lock cylinder and keys	Paddle handle boxes
003-CH505CYLNDR	Lock cylinder and keys	Paddle handle boxes
003-CH506CYLNDR	Lock cylinder and keys	Paddle handle boxes
003-CH507CYLNDR	Lock cylinder and keys	Paddle handle boxes
003-CH508CYLNDR	Lock cylinder and keys	Paddle handle boxes
003-CH509CYLNDR	Lock cylinder and keys	Paddle handle boxes
003-CH510CYLNDR	Lock cylinder and keys	Paddle handle boxes
003-HDL	Locking pull handle	Pull handle boxes
003-HDL-KEY0001	Replacement key	Pull handle boxes
003-HDL-KEY0002	Replacement key	Pull handle boxes
003-HDL-KEY0003	Replacement key	Pull handle boxes
003-HDL-KEY0004	Replacement key	Pull handle boxes
003-HDL-KEY0005	Replacement key	Pull handle boxes
003-HDL-KEY0006	Replacement key	Pull handle boxes
003-HDL-KEY0007	Replacement key	Pull handle boxes
003-HDL-KEY0008	Replacement key	Pull handle boxes
003-HDL-KEY0009	Replacement key	Pull handle boxes
003-HDL-KEY0010	Replacement key	Pull handle boxes
003-HDNL	Nonlocking pull handle	Pull handle boxes
003-NHPIN	Nail head striker pin, 1/4"	All boxes, excluding Secure Lock
003-RIVET-BLK	Black rivets, 3/16"	All boxes
003-RYTHCY-001	T-handle lock cylinder and keys	Topside, underbody, drawer, and dog boxes
003-RYTHCY-002	T-handle lock cylinder and keys	Topside, underbody, drawer, and dog boxes
003-RYTHCY-003	T-handle lock cylinder and keys	Topside, underbody, drawer, and dog boxes
003-RYTHCY-004	T-handle lock cylinder and keys	Topside, underbody, drawer, and dog boxes
003-RYTHCY-005	T-handle lock cylinder and keys	Topside, underbody, drawer, and dog boxes
003-RYTHCY-006	T-handle lock cylinder and keys	Topside, underbody, drawer, and dog boxes

* Continued while supplies last

Part #	Description	Fits
003-RYTHCY-007	T-handle lock cylinder and keys	Topside, underbody, drawer, and dog boxes
003-RYTHCY-008	T-handle lock cylinder and keys	Topside, underbody, drawer, and dog boxes
003-RYTHCY-009	T-handle lock cylinder and keys	Topside, underbody, drawer, and dog boxes
003-RYTHCY-010	T-handle lock cylinder and keys	Topside, underbody, drawer, and dog boxes
003-SLLKBLK	Lockable handle	Secure Lock boxes
003-USTRIKER	Secure lock striker	Secure Lock boxes
003-001LC	Lock core replacement	Pull handle boxes
003-002LC	Lock core replacement	Pull handle boxes
003-002THLC*	T-handle lock cylinder and keys	Topside, underbody, drawer, and dog boxes
003-003LC	Lock core replacement	Pull handle boxes
003-004LC	Lock core replacement	Pull handle boxes
003-004THLC*	T-handle lock cylinder and keys	Topside, underbody, drawer, and dog boxes
003-005LC	Lock core replacement	Pull handle boxes
003-005THLC*	T-handle lock cylinder and keys	Topside, underbody, drawer, and dog boxes
003-006LC	Lock core replacement	Pull handle boxes
003-006THLC*	T-handle lock cylinder and keys	Topside, underbody, drawer, and dog boxes
003-007LC	Lock core replacement	Pull handle boxes
003-008LC	Lock core replacement	Pull handle boxes
003-008THLC*	T-handle lock cylinder and keys	Topside, underbody, drawer, and dog boxes
003-009LC	Lock core replacement	Pull handle boxes
003-009THLC*	T-handle lock cylinder and keys	Topside, underbody, drawer, and dog boxes
003-010LC	Lock core replacement	Pull handle boxes
003-010THLC*	T-handle lock cylinder and keys	Topside, underbody, drawer, and dog boxes
UWS-BALL-STUD	10mm ball stud	All boxes with lift cylinder
UWS-BLD69A	Replacement BedRug™ liner	Secure Lock boxes (deep 69" angled)
UWS-BL69	Replacement BedRug liner	Secure Lock boxes (standard 69")
UWS-BL72	Replacement BedRug liner	Secure Lock boxes (standard 72")
UWS-BOXFOAM	Foam for bed rail protection	All crossover boxes
UWS-CABLE	12" stainless cable with eyes	Topside and underbody boxes
UWS-CAPS	Fuel cap	All transfer tanks
UWS-DSDIVIDER	Plastic divider, 3"	Drawer boxes
UWS-GRABHANDLE	Grab handle	TBC-38-DS (truck utility box with drawers)
UWS-HOOK60	Velcro hook, 1" x 60"	Secure Lock boxes
UWS-JBOLTKIT	J-bolt kit	All crossover boxes
UWS-LIFT-CYLIND	Lift cylinder	All boxes with 45 lb. lift cylinder
UWS-LOCKING	Locking paddle handle	All paddle handle boxes
UWS-MAGNETPULL	Magnetic door catch	TBC-38-DS (truck utility box with drawers)
UWS-NONLOCKING	Non locking paddle handle	All two-handle paddle handle boxes
UWS-P-TRAYS	Plastic tray	All standard crossover boxes
UWS-PULLHANDLE	Chest handles	ATV, foot locker, and tote boxes
UWS-ROD-CONNECT	Rod connector with set screw	All two-handle boxes
UWS-SBRACKET	Striker bracket	All boxes excluding TB-1 and TB-2
UWS-TCA	Top cylinder bracket assembly	All boxes with lift cylinders
UWS-THLOCK	Folding T-handle, locking	Topside, underbody, dog boxes, and fender boxes
UWS-TWISTLOCK	Twist lock	Tote boxes
UWS-1-4KEPNUT	Kep nut, 1/4"	Multiple applications
UWS-34CLOSEDCEL	MicroSeal™ gasket	Topside, underbody, dog boxes, and fender boxes
UWS-125FOAM	Truck tool box lid gasket foam	All crossover boxes
UWSLGLIFTCYLNR	Extra long lift cylinder	Extra-wide crossover models only

* Continued while supplies last



Scan QR code to see how we take care of shipping!



DAMAGE-FREE DELIVERY GUARANTEED

HEAVY-DUTY PACKAGING ENSURES YOUR PRODUCT IS PROTECTED

With our heavy-duty packaging initiative, we take the extra steps needed to ensure a damage-free product. Our process is specially designed to withstand the rigors of parcel shipping, ensuring your order arrives in the same condition as it left our facility. Check out the table to view our available heavy-duty packaging options.

ADVANTAGES OF HEAVY-DUTY PACKAGING



Large products are placed in a thick, secondary box that provides double the protection

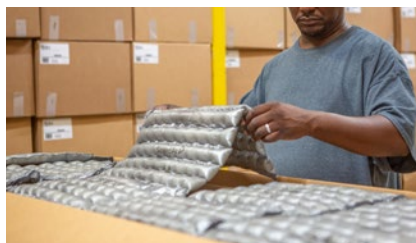

Expanding foam is used to fill the box and cradle the product, preventing movement and damage

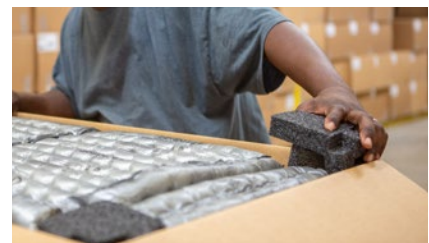

The corners of each box are protected with foam bumpers to further protect from impacts during transport

Standard Part #	HD Pkg Part #
SL-69-LP	EC10001
SL-69-LP-MB	EC10013
SL-72-LP	EC10021
SL-72-LP-MB	EC10033
TB-60	EC10041
TB-63	EC10051
TB-69	EC10061
TB-72	EC10071
TBS-54	EC10081
TBS-54-BLK	EC10092
TBS-54-LP	EC10101
TBS-54-LP-BLK	EC10112
TBS-58-LP	EC10141
TBS-58-LP-BLK	EC10152
TBS-60	EC10161
TBS-60-A	EC10171
TBS-60-A-BLK	EC10182
TBS-60-A-LP	EC10191
TBS-60-A-LP-BLK	EC10202
TBS-60-BLK	EC10212
TBS-60-LP	EC10221
TBS-60-LP-BLK	EC10232
TBS-60-SL	EC10241
TBS-60-SL-BLK	EC10252
TBS-63	EC10261
TBS-63-A	EC10271
TBS-63-A-BLK	EC10282
TBS-63-A-LP	EC10291
TBS-63-A-LP-BLK	EC10302
TBS-63-SL-LP	EC10311
TBS-63-SL-LP-B	EC10312
TBS-63-A-LP-MB	EC10313
TBS-63-BLK	EC10322
TBS-63-LP	EC10331
TBS-63-LP-BLK	EC10342
TBS-63-SL	EC10351
TBS-63-SL-BLK	EC10362
TBS-66	EC10371
TBS-66-BLK	EC10382
TBS-66-LP	EC10391
TBS-66-LP-BLK	EC10402
TBS-69	EC10411
TBS-69-A-LP	EC10421
TBS-69-A-LP-BLK	EC10432
TBS-69-BLK	EC10442
TBS-69-LP	EC10451
TBS-69-LP-BLK	EC10462
TBS-69-LP-MB	EC10473
TBS-69-LP-PH	EC10481
TBS-69-LP-PH-B	EC10492
TBS-69-LP-PH-MB	EC10503
TBS-69-MB	EC10513
TBS-69-SL	EC10521
TBS-69-SL-BLK	EC10532
TBS-69-SL-LP	EC10541
TBS-69-SL-LP-B	EC10552
TBS-72	EC10561
TBS-72-BLK	EC10572
TBS-72-LP	EC10581
TBS-72-LP-BLK	EC10592

Standard Part #	HD Pkg Part #
TBS-72-LP-MB	EC10603
TBS-72-LP-PH	EC10611
TBS-72-LP-PH-B	EC10622
TBS-72-LP-PH-MB	EC10633
TBS-72-MB	EC10643
TBS-72-SL	EC10651
TBS-72-SL-BLK	EC10662
TBSD-69-A-LP	EC10761
TBSD-69-A-LP-B	EC10772
TBSD-69-A-LP-MB	EC10783
TBSD-69-LP	EC10791
TBSD-69-LP-BLK	EC10802
TBSD-69-SL	EC10811
TBSD-69-SL-BLK	EC10822
TBSD-69-SL-LP	EC10831
TBSD-69-SL-LP-B	EC10842
TBSD-72-SL-LP	EC10871
TBSD-72-SL-LP-B	EC10882
UTV-59-MB	EC10893
8500002	EC10893-CA
8500004	EC10893-HP
8500003	EC10893-KM
8500000	EC10893-PR
8500001	EC10893-YV
UTV-59PR-MB	EC10903
8500005	EC10903-PR
UTV-SM33-MB	EC10993
SL-63-A-LP	EC11021
SL-63-A-LP-MB	EC11023
ATV	EC20001
ATV-BLK	EC20012
DS-18	EC20021
DS-18-BLK	EC20032
DS-22	EC20041
DS-22-BLK	EC20052
FOOT-LOCKER	EC20061
FOOT-LOCKER-BLK	EC20072
FWB-58	EC20081
FWB-58-BLK	EC20092
FWB-58-MB	EC20093
TB-1	EC20101
TB-2	EC20111
TBC-30	EC20121
TBC-30-BLK	EC20132
TBC-36	EC20141
TBC-36-BLK	EC20152
TBC-36-W	EC20161
TBC-36-W-BLK	EC20172
TBC-42	EC20201
TBC-42-BLK	EC20212
TBC-42-W	EC20221
TBC-42-W-BLK	EC20232
TBC-48	EC20241
TBC-48-BLK	EC20252
TBC-48-DD	EC20261
TBC-48-W	EC20271
TBC-48-W-BLK	EC20282
TBC-55-W	EC20291
TBC-55-W-BLK	EC20302
TBC-55-WN	EC20311

Standard Part #	HD Pkg Part #
TBC-55-WN-BLK	EC20322
TBC-60-N	EC20331
TBC-60-N-BLK	EC20342
TBC-60-W	EC20351
TBC-60-W-BLK	EC20362
TBC-62-WN	EC20371
TBC-62-WN-BLK	EC20382
TBV-34	EC20391
TBV-34-BLK	EC20402
TBV-34-LP	EC20411
TBV-34-LP-BLK	EC20422
TBV-49	EC20431
TBV-49-BLK	EC20442
SLC-48	EC20501
SLC-48-MB	EC20503
FW-48-DS-D	EC30001
FW-48-DS-D-BLK	EC30012
FW-48-DS-P	EC30021
FW-48-DS-P-BLK	EC30032
TBSM-36	EC30071
--	EC30071-MK2
TBSM-36-BLK	EC30082
--	EC30082-MK2
TBSM-48	EC30091
--	EC30091-MK2
TBSM-48-BLK	EC30102
--	EC30102-MK2
TBSM-60	EC30111
--	EC30111-MK2
TBSM-60-BLK	EC30122
--	EC30122-MK2
TBSM-72	EC30131
--	EC30131-MK2
TBSM-72-BLK	EC30142
--	EC30142-MK2
TBSM-48-LP	EC30201
--	EC30201-MK2
TBSM-48-LP-BLK	EC30202
--	EC30202-MK2
TBSM-48-LP-MB	EC30203
--	EC30203-MK2
TBSM-36-LP	EC30361
--	EC30361-MK2
TBSM-36-LP-BLK	EC30362
--	EC30362-MK2
TBSM-36-LP-MB	EC30363
--	EC30363-MK2
TBTS-48	EC40001
TBTS-48-BLK	EC40012
TBTS-60	EC40021
TBTS-60-BLK	EC40032
TBTS-72	EC40041
TBTS-72-BLK	EC40052
TBUB-24	EC40061
TBUB-30	EC40071
TBUB-36	EC40081
TBUB-36-BLK	EC40092
TBUB-48	EC40101
TBUB-60	EC40111

-MK2 part #s include adjustable side mount legs



UWS
SECURE LOCK UNDER TONNEAU CHEST BOX
 FITS MOST TONNEAUS.
 SECURE LOCK HANDLES.
 PATENTED LID DESIGN.

UWS
Tough. Reliable. USA-Assembled.
 Dependability does not come automatically. It has to be earned through dedication, consistency and hard work. At UWS, we are determined to provide reliable products for hardworking individuals. That is why each of our tool boxes is engineered with care and crafted for tough jobs.
 uwsusa.com

Patented RigidCore™, foam-filled lid

0.058" extra-thick, one-piece aluminum

MARKETING SUPPORT



UWS UNIVERSITY



Scan or visit
uwsta.com/university

UWS University is a self-service learning tool for UWS products and resources that provides easy access to nearly all of our marketing support materials. It is designed to educate our customers to enhance their sales and grow their business!

POINT-OF-PURCHASE



Catalog



Banner



Window sticker

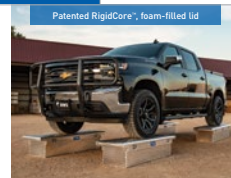
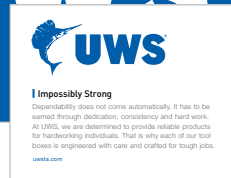

Display signage

Literature & Catalog

- Accordion-fold literature (8-1/2' x 3-1/2') focuses on educating the consumer about the advantages of UWS tool boxes
- The catalog provides a complete listing of UWS products and vehicle applications
- Clear plastic stands available for displaying literature

Banner & Retail Signage

- Bold graphics and clear messaging to draw attention to your store
- Banner for use in-store and outdoors to help identify and promote your UWS tool box offering

Display & Signage

- Floor stand display can mount various tool boxes
- Promotional placards for use on display stands or as in-store signage to help promote key UWS tool box features. Set includes:
 - Header card
 - Tool tray insert
 - Built-in features insert
 - Product features header
- Contact your UWS sales representative to determine the products best tailored to your needs



Display stand with included header card (tool boxes sold separately)

Contact your sales representative for a complete list of available items and how to qualify.



LIMITED LIFETIME WARRANTY

UWS provides limited lifetime warranty coverage against defects in factory workmanship and materials for UWS products ("Products") sold by factory authorized dealers for use by retail (end use) consumers. This Limited Warranty is provided only to the original Product consumer, and applies only to the original installation. This Limited Warranty is not transferrable and does not extend or apply to anyone else. For consumers in the U.S.: this Limited Warranty gives you specific legal rights; you also may have other rights, which vary from state to state.

This Limited Warranty is the sole and exclusive warranty provided by UWS, and all other warranties and conditions are excluded and disclaimed. **UNDER THE LAW OF CERTAIN STATES, THERE MAY BE NO IMPLIED CONDITIONS OR WARRANTIES FROM UWS APPLICABLE TO YOUR PRODUCT, AND ALL IMPLIED CONDITIONS OR WARRANTIES (INCLUDING ANY WARRANTY OF MERCHANTABILITY OR FITNESS FOR A PARTICULAR PURPOSE) ARE EXCLUDED AND DISCLAIMED WHERE ALLOWED BY LAW.** If implied warranties are imposed under any applicable state law, all such implied warranties are limited to the duration of the applicable provisions of this Limited Warranty. For consumers in the U.S.: some states do not allow limitations on how long an implied warranty lasts, so the above limitation may not apply to you.

COVERED PRODUCTS AND LIMITATIONS

UWS provides the following Limited Warranty coverage:

Product	Workmanship & Materials	Components & Parts	Finishings & Coatings
All storage boxes	Limited lifetime	1-year	1-year
Other accessories	Lifetime	1-year	1-year

Each of the warranty coverage periods runs from the date of purchase of the Product (proof of purchase is required) and applies only to warranted defects that first occur and are reported to UWS within the applicable warranty period. UWS retains the right to determine to its reasonable satisfaction whether any claimed defect is covered by this Limited Warranty.

Certain items are excluded from Limited Warranty coverage by UWS, and this **Limited Warranty coverage does not apply to:**

- Wear and tear from normal use, including damage from road debris
- Improper product selection, application, installation or maintenance
- Modifications, including the attachment of other hardware or components
- Misuse, abuse, overloading, improper trailering or hauling, accident
- Corrosion or damage due to environmental conditions

REMEDIES UNDER THIS LIMITED WARRANTY

If a defect covered by this warranty occurs, UWS will repair or replace the Product, or refund the purchase price, in its sole discretion. This "repair, replacement or refund" remedy is the **sole and exclusive remedy** under this Limited Warranty. UWS has **no responsibility or liability for any incidental or consequential damages**, such as loss of use of vehicles or trailers, towing charges, storage charges, labor and service charges for removing or reinstalling products, loss of or damage to personal property, or interest or finance charges, all of which are specifically **excluded and disclaimed** from this Limited Warranty. For consumers in the U.S.: some states do not allow the exclusion or limitation of incidental or consequential damages, so the above limitation or exclusion may not apply to you.

RESPONSIBILITY OF PURCHASER

The Purchaser must have proof of purchase to obtain service under this Limited Warranty. Contact UWS for a Returned Goods Authorization (RGA) and return instructions; UWS will not accept Products unless an RGA has been issued. The Purchaser must deliver the Product to UWS or an authorized UWS dealer along with the RGA number and proof of purchase.

The UWS Limited Warranty policy in effect on the date you purchased your Product determines the applicable warranty coverage, and subsequent or prior UWS warranties are not applicable to your Product. The terms of this Limited Warranty cannot be changed or modified, except by a written agreement signed by an officer of UWS. UWS reserves the right to improve its products through changes in design or materials without being obligated to the owners of the Products of the same or similar models.

Contact information:

UWS Headquarters
6208 Industrial Drive
Eau Claire, WI 54701
877.287.8634



IMPOSSIBLY STRONG.



Building a reputation for dependability does not come automatically — it must be earned. Whether it's an individual, a truck or a piece of equipment, earning a reputation for being dependable is something that comes through consistent performance and intentional quality.

At UWS, we design and build dependable products for hardworking trucks and people. That's why our tool boxes are assembled domestically in the USA and why we continue to innovate and enhance the quality of each product in our lineup, year after year.

We build tool boxes and products that are made for those who are dependable and require dependable equipment — from ranchers to contractors to sportsmen and everyday American families.

At UWS our goal is to build products our consumers are proud to mount in their trucks and can rely on for years to come. UWS gives you reliable security and confidence to protect your gear and to achieve a job well done.

**TO SEE OUR WARRANTY,
VISIT UWSTA.COM**



CONNECT WITH US



PHONE
877.287.8634



WEB
UWSTA.COM



SOCIAL MEDIA
@CURTMFG / #UWS

LOCATIONS

HEADQUARTERS

6208 INDUSTRIAL DRIVE
EAU CLAIRE, WI 54701

DALLAS

3535 N HOUSTON SCHOOL ROAD
SUITE 400
LANCASTER, TX 75134

EDMONTON

12642 184TH STREET NW
UNIT #2
EDMONTON, ALBERTA T5V 1T4

PERRY

606 INDUSTRIAL PARK DRIVE
PERRY, FL 32348

SEATTLE

6546 20TH STREET EAST
FIFE, WA 98424

TORONTO

845 INTERMODAL DRIVE
UNIT #1
BRAMPTON, ON L6T 5W2